

IN-LINE RECEPTACLE

with standard compression nut



Types
ZRLD
ZRED

To specify a complete receptacle, substitute the Dash No. of the contact insert selected, for the Asterisk (*) in the Catalog No. below.

Size Cable	Shell Size	Cat. No. With Standard Coupling Nut	DIMENSIONS				
			A	C	D	E	
Select from Table Below and Substitute Symbol No. for Delta Δ	12	ZRLD-Δ 12-*	5 3/8	6	1 3/4	1 61/64	
	16	ZRLD-Δ 16-*	5 5/8	6 1/4	2 1/4	2 31/64	
	20	ZRLD-Δ 20-*	6 1/8	6 3/4	2 3/4	3 1/32	
	C20	ZRLD-Δ C20-*	6 5/8	7 1/4	2 3/4	3 1/32	
	24	ZRLD-Δ 24-*	6 5/8	7 1/4	3 1/4	3 9/16	
	C24	ZRLD-Δ C24-*	7 1/8	7 3/4	3 1/4	3 9/16	
	28	ZRLD-Δ 28-*	7 1/8	7 3/4	3 3/4	4 1/16	
	C28	ZRLD-Δ C28-*	7 5/8	8 1/4	3 3/4	4 1/16	
	WITH LONG CABLE ADAPTER						
	12	ZRLDL-Δ 12-*	7 5/8	8 1/4	1 3/4	1 51/64	
16	ZRLDL-Δ 16-*	7 7/8	8 1/2	2 1/4	2 31/64		
20	ZRLDL-Δ 20-*	8 3/8	9	2 3/4	3 1/32		
C20	ZRLDL-Δ C20-*	8 7/8	9 1/2	2 3/4	3 1/32		
24	ZRLDL-Δ 24-*	8 7/8	9 1/2	3 1/4	3 9/16		
C24	ZRLDL-Δ C24-*	9 3/8	10	3 1/4	3 9/16		
28	ZRLDL-Δ 28-*	9 1/8	9 3/4	3 3/4	4 1/16		
C28	ZRLDL-Δ C28-*	9 5/8	10 1/4	3 3/4	4 1/16		

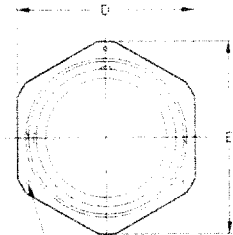
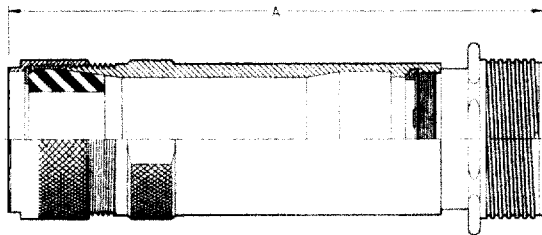

SAFETY WIRE HOLES
(3) .062 DIA.

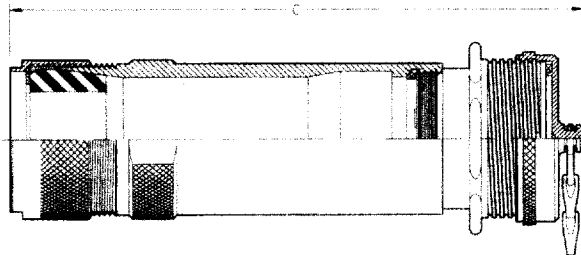

To specify receptacle with threaded environmental cover, change third letter in Part No. "L" to "E". Example: ZRLD changes to ZRED.

OIL-RESISTANT RUBBER GROMMETS—SYMBOL NUMBERS OF SIZES AVAILABLE

Substitute the symbol Number for the Delta Δ in the Catalog Number of Plug.
Example: ZRLD-Δ 12-* for .500 to .625 Dia. Cable changes to ZRLD-10 12-*.

Cable Dia.	Shell 12	Shell 16	Shells 20 & C20	Shells 24 & C24	Shells 28 & C28	Cable Dia.	Shell 12	Shell 16	Shells 20 & C20	Shells 24 & C24	Shells 28 & C28
.062 to .125	02	1.500 to 1.625	26	26	26
.125 to .250	04	1.625 to 1.750	28	28	28
.250 to .375	06	06	1.750 to 1.875	30	30	30
.375 to .500	08	08	1.875 to 1.937	31
.500 to .625	10	10	10	1.875 to 2.000	32	32
.625 to .750	12	12	12	2.000 to 2.125	34	34
.750 to .875	14	14	14	2.125 to 2.250	36	36
.875 to .937	15	2.250 to 2.375	38	38
.875 to 1.000	..	16	16	16	..	2.375 to 2.437	39	..
1.000 to 1.125	..	18	18	18	..	2.375 to 2.500	40
1.125 to 1.250	..	20	20	20	..	2.500 to 2.625	42
1.250 to 1.375	..	22	22	22	..	2.625 to 2.750	44
1.375 to 1.437	..	23	2.750 to 2.875	46
1.375 to 1.500	24	24	24						