

Nominal diameter Withdraw. force Rated current Contact resistance

2 mm - 15 A -

Type Part No

LB 2-R 23.0000
with round nu

Grounding jack 2 mm (.080 in) dia., non-insulated, machined brass, nickel plated with solder cup.

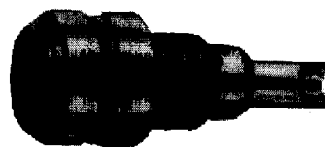

Components:

- Jack B-LB 2R # 23.5058
- Round nut MuR/M6x0.5 # 23.5100
- Hex nut Mu/M6x0.5 # 23.5104
- Washer U/Sp2 # 23.5105

Tool:

- Special spanner SS 2 # 25.0022
(for round nuts)

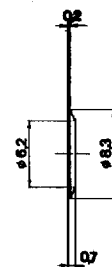
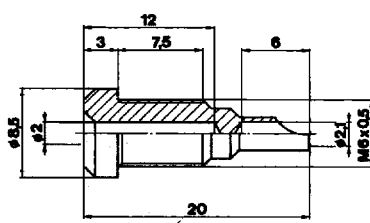

washer only
23.5105

round nut only
23.5100

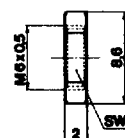
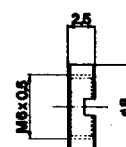

hex nut only
23.5104

1.5.1

2 mm - 10 A -

EB 2 23.1011

Press-in panel mount jack 2 mm (.080 in) dia., machined brass, gold plated, polyamide insulated, with flat tab 2.8 x 0.8 mm (.110 x .031 in).



Components and ratings:

- Socket B-EB 2 # 23.5010
- Insulator I-EB 2 # 23.5011
- Breakdown/flashover voltage with 3 mm (.120 in) panel thickness: 5000 V
- Test voltage: 1500 V
- Operating temperature: -40°C to +80°C
(-40°F to 176°F)

Colors: 20 - 29

Tools:

- Mounting tool MB 2 # 25.0031
- Drill 4.9 mm (.193 in) dia. HSS 4.9 # 25.0041

Accessory:

- Flat push-on terminal FSH 2.8 x 0.8 mm (.110 x .031 in) brass, gold plated, for conductors 0.5 - 1 mm² (20 - 17 AWG)
- FSH 2.8 x 0.8 mm # 23.5200

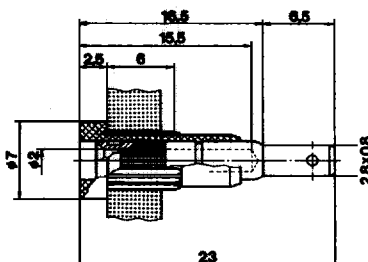

Delivered in parts
B-EB 2 23.5010
I-EB 2 23.5011

1.5.1

For assembly, see page 29.

20 - green/yellow 21 - black 22 - red 23 - blue 24 - yellow 25 - green 26 - violet 27 - brown 28 - gray 29 - white 33 - transparent

Part No.	Type		Nominal diameter	Withdraw. force	Rated current	Contact resistance
23.1021	EB 2-F		2 mm	-	10 A	0.5 mΩ



Press-in panel mount jack 2 mm (.080 in) dia., spring-loaded with gold plated MC®-Multilam™. Machined brass, optalloy® plated, polyamide insulated.

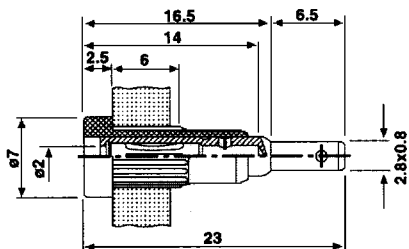

Delivered in parts
 B-EB 2F 23.5005
 I-EB 2 23.5011

- Components and ratings:
- Socket B-EB 2-F # 23.5005
 - Insulator I-EB 2 # 23.5011
 - Breakdown/flashover voltage with 3 mm (.120 in) panel thickness: 5000 V
 - Test voltage: 1500 V
 - Operating temperature: -40°C to +80°C (-40°F to 176°F)

Colors: 20 - 29

- Tools:
- Mounting tool MB 2 # 25.0031
 - Drill 4.9 mm (.193 in) dia. HSS 4.9 # 25.0041

- Accessory:
- Flat push-on terminal FSH 2.8 x 0.8 mm (.110 x .031 in) brass, gold plated, for conductors 0.5 - 1 mm² (20 - 17 AWG) FSH 2.8 x 0.8 mm # 23.5200

1:5:1

23.1012	EB 2-A		2 mm	-	10 A	-
---------	--------	--	------	---	------	---



Press-in panel mount jack 2 mm (.080 in) dia., machined brass, gold plated, polyamide insulated, with round tab.

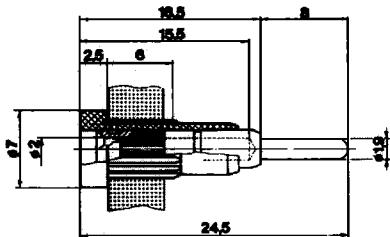

- Components and ratings:
- Socket B-EB 2-A # 23.5002
 - Insulator I-EB 2 # 23.5011
 - Breakdown/flashover voltage with 3 mm (.120 in) panel thickness: 5000 V
 - Test voltage: 1500 V
 - Operating temperature: -40°C to +80°C (-40°F to 176°F)

Colors: 20 - 29

- Tools:
- Mounting tool MB 2 # 25.0031
 - Drill 4.9 mm (.193 in) dia. HSS 4.9 # 25.0041

- Accessory:
- Round connecting receptacle RSH 1.9 mm (.075 in) brass, gold plated # 23.5202

1:5:1

For assembly, see page 29.

Nominal diameter Withdraw. force Rated current Contact resistance

Type Part No

2 mm - 10 A -

EB 2-WR 23.1021

Press-in panel mount jack 2 mm (.080 in) dia., machined brass, nickel plated, polyamide insulated, with wire-wrap connecting pin 1 mm x 1 mm (.040 in x .040 in).



Ratings:
Breakdown/flashover voltage: 5000 V with 3 mm (.120 in) panel thickness
Test voltage: 1500 V
Operating temperature: -40°C to +80°C (-40°F to 176°F)

Colors: 20 - 29
For assembly, see page 29.

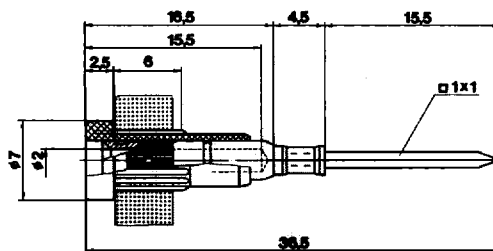

1.5:1

2 mm - 10 A -

SEB2-R 65.9191

Insulated 2 mm safety socket, rated 600 V, CAT III, 10A, fully insulated, press-in, 2 mm safety socket with round gold-plated brass pin for connecting purposes. Can be pressed into predrilled panels of plastic, metal, etc.
Voltage: 600 V, CAT III
Operating temperature: -40°C to +80°C (-40°F to 176°F)

Colors: 21 - 25, 29

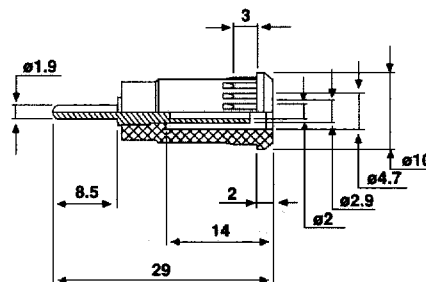

1:1



2 mm - 10 A -

SLB2-R 65.9191

Insulated 2 mm safety socket, rated 600 V, CAT III, 10 A, fully insulated, screw-mounted, 2 mm safety socket with round gold-plated brass pin for connecting purposes. Can be mounted into predrilled panels of plastic, metal, etc.
Voltage: 600 V, CAT III
Operating temperature: -40°C to +80°C (-40°F to 176°F)

Colors: 21 - 25, 29

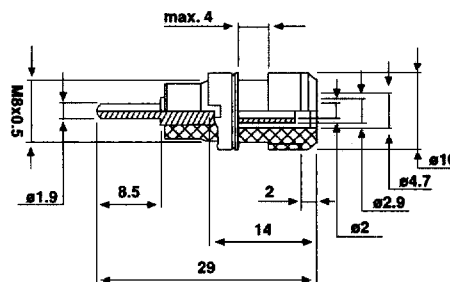

1:1



Part No.	Type	Nominal diameter	Withdraw. force	Rated current	Contact resistance
----------	------	------------------	-----------------	---------------	--------------------

23.0060
with hex nut

LB-IF 2 R



2 mm - 10 A 0.8 mΩ

23.0020
with round nut

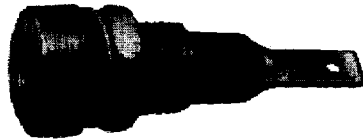

Screw-in panel mount jack 2 mm (.080 in) dia., spring-loaded with gold plated MC®-Multilam™, polyamide insulated.

Machined brass, Trilux finish, metal threaded jacket for high mounting strength with flat tab 2.8 x 0.8 mm (.110 x .031 in).

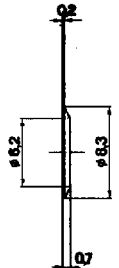
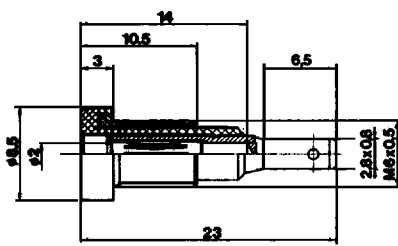

washer only
23.5105

round nut only
23.5100

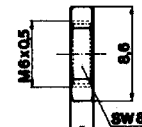
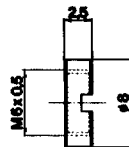

hex nut only
23.5104

Components and ratings:

- Jack BI-LB-IF2R # 23.5021
- Hex nut Mu/M6x0.5 # 23.5104
- Washer Sp 2 # 23.5105
- Round nut MuR/M6x0.5 # 23.5100
- Breakdown/flashover voltage with 5000 V
3 mm (.120 in) panel thickness
- Test voltage: 2000 V

Colors: 20 - 29

Tool: Special spanner SS 2 #25.0022 (for round nuts)

1.5:1

23.0030
with hex nut

LB-I 2 R

2 mm - 10 A -

23.0040
with round nut



Screw-on panel mount jack 2 mm (.080 in) dia., polyamide insulated.

Machined brass, Trilux finish, metal threaded jacket for high mounting strength with flat tab 2.8 x 0.8 mm (.110 x .031 in).

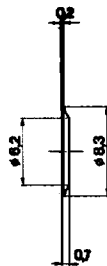
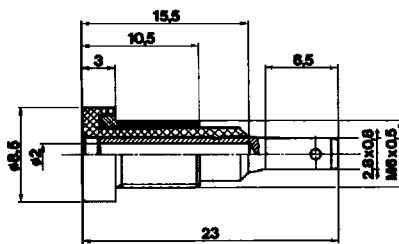

washer only
23.5105

round nut only
23.5100

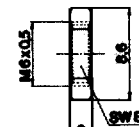
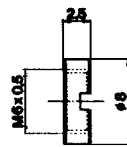

hex nut only
23.5104

Components and ratings:

- Jack BI-LB-I2R # 23.5059
- Round nut MuR/M6x0.5 # 23.5100
- Hex nut Mu/M6x0.5 # 23.5104
- Washer Sp2 # 23.5105
- Breakdown/flashover voltage with 5000 V
3 mm (.120 in) panel thickness:
- Test voltage: 2000 V
- Operating temperature: -40°C to +80°C
(-40°F to 176°F)

Colors: 20 - 29

Tool: Special spanner SS 2, # 25.0022 (for round nuts)

1.5:1

Accessory:

- Flat push-on terminal FSH 2.8 x 0.8 mm (.110 x .031 in) brass, gold plated, for conductors 0.5 - 1 mm² (20 -17 AWG) FSH 2.8 x 0.8 mm # 23.5200

20 - green/yellow 21 - black 22 - red 23 - blue 24 - yellow 25 - green 26 - violet 27 - brown 28 - gray 29 - white 33 - transparent

Nominal diameter Withdraw. force Rated current Contact resistance

Type

Part No

2 mm - 15 A -

HLB 2-G 23.0230

High voltage screw-on, panel mount jack 2 mm (.080 in) dia., polyamide insulated. Machined brass, gold plated with M 4 threaded post.



Components and ratings:

- Jack BI-HLB 2-G # 23.7333
- Hex nut Mu0.8d/M4 # 22.6509
- Washer (2) U/M4 # 22.6511
- Round nut MuR/M12x0.75 # 23.5120
- Washer SSP4 # 23.5108
- Rated voltage: 1500 V, CAT I
- Test voltage: 5000 V
- Flashover voltage with test finger (VDE 0470 part 1/9.80): 9500 V
- Breakdown/flashover voltage with 5 mm (.200 in) panel thickness: > 10,000V

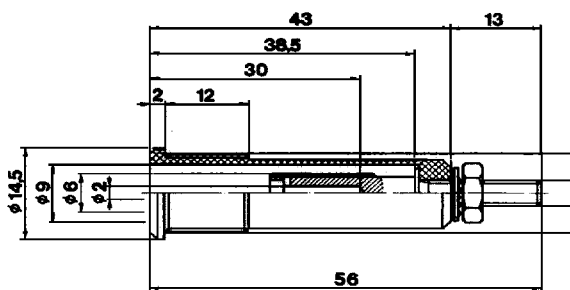

Colors: 21 - 23,

Tool: Special spanner SS 425 # 25.0020 (for round nuts MuR/M12 x 0.75)

For matching high voltage patch cord HLK 218-L, #21.0870, see page 85.

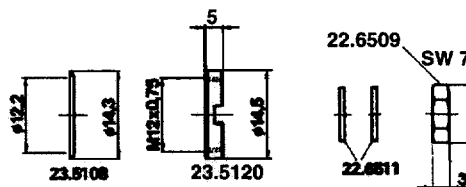

1:1.2

2 mm - 10 A -

B-2 N 63.9286
B-2 G nickel-plated

2 mm non-insulated press-fit socket, is designed for press-fit in plastic cases. The socket is produced in rolled brass with an option of nickel or gold finish. Weight: 0.4 g.

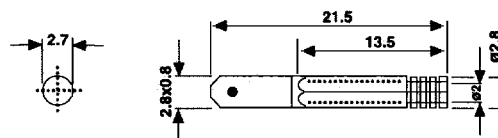

B-2 N - nickel-plated: Order code # 63.9282
B-2 G - gold-plated: Order code # 63.9283



1.5:1

2 mm - 10 A -

EPB-2 N 63.9286
EPB-2 G nickel-plated

2 mm insulated press-fit socket is assembled by first pushing the insulator into a Ø 3.9 hole, into which the socket is then inserted. Weight: 0.5 g.

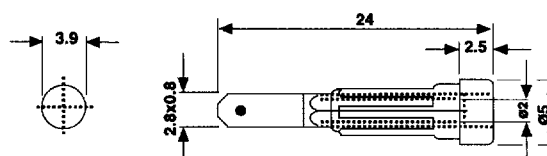

Colors: 21, 22, 23, 24, 25, 29

EPB-2 N - nickel-plated: Order code # 63.9286
EPB-2 G - gold-plated: Order code # 63.9287



1.5:1

Mounting tool: Special MB-2, # 63.8316

20 - green/yellow 21 - black 22 - red 23 - blue 24 - yellow 25 - green 26 - violet 27 - brown 28 - gray 29 - white 33 - transparent