

# 423 Series: | Ø 7.4 mm Mounting Domed Lens (Neon)

- Medium voltage neon styles
- Front panel replaceability
- Robust socket for high vibration applications (see below and page 28)
- MLC 20
- Half life 25,000 hrs (10,000 Green)

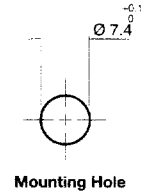
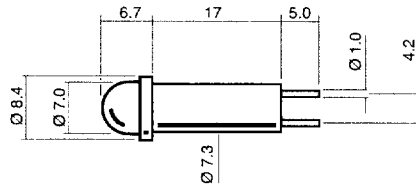

Scale 1 : 1  
Dimensions in mm (Typical)

## Ordering information and technical characteristics (Ta = 25°C)

Order code	Colour	Lens	Voltage AC Vopr	Current AC Iopr	Luminous Flux $\phi_v@ Iopr$	Viewing Angle (Inclusive)	Operating Temp Topr	Storage Temp Tstg
423 - 596 - 75	Red	Coloured Diffused	110	1.5	0.2	180	0 to +85	0 to +85
423 - 598 - 75	Orange		110	1.5	0.2			
423 - 597 - 75	Green		110	1.5	0.2			
423 - 596 - 76	Red		240	1.8	0.3			
423 - 598 - 76	Orange		240	1.8	0.3			
423 - 597 - 76	Green		240	1.8	0.3			
			V	mA	Lm	deg	°C	°C