

SHELL	A±0.38	B±0.12	C±0.10	D±0.25	E±0.07	G±0.25
09	30.81	24.99	16.96	16.79	10.96	5.90
15	39.14	33.32	25.18	25.12	19.18	5.90
25	53.03	47.04	39.12	38.84	33.12	5.70
37	69.32	63.50	55.68	55.30	49.68	5.70

GENERAL CHARACTERISTICS : SEE DWG.NO: C01-8646-0000

PC card drilling dimensions(after plating)
(thickness 1.60±0.20mm)

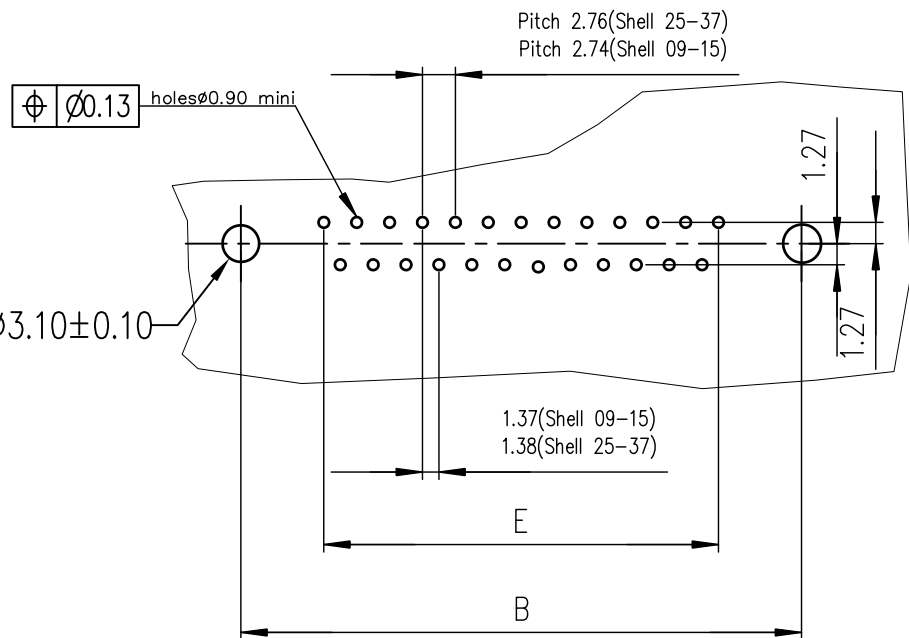

SHELL	PART NUMBER	DESIGNATIONS
09	D09P13A*G*00**	HEADER 9 CTS RIGHT ANGLED-SOLDER TO BOARD-PCB HARPOON-SCREWLOCK -ELEC.CONTIN.
15	D15P13A*G*00**	HEADER 15 CTS RIGHT ANGLED-SOLDER TO BOARD-PCB HARPOON-SCREWLOCK -ELEC.CONTIN.
25	D25P13A*G*00**	HEADER 25 CTS RIGHT ANGLED-SOLDER TO BOARD-PCB HARPOON-SCREWLOCK -ELEC.CONTIN.
37	D37P13A*G*00**	HEADER 37 CTS RIGHT ANGLED-SOLDER TO BOARD-PCB HARPOON-SCREWLOCK -ELEC.CONTIN.

4 = Performance level PL3 ≥ 200 OPERATIONS
6 = Performance level PL1 ≥ 500 OPERATIONS
I = SCREWLOCK Threaded M3
V = SCREWLOCK Threaded UNC 4.40 sellers

mat'l. code				surface		tolerance		projection		product family	
SEE NOTES				ISO 1302 ✓		ISO 406 ISO 1101		MM		DELTA-D	
ltr	ecn no	dr	date	tolerances unless otherwise specified		0.X± 0.1		MM		title	
D	I05-0124	JS	2005/07/27	angles	linear	0.XX± 0.1		MM		MALE DELTA-D RIGHT ANGLED	
E	I06-0074	SK	2006/06/08	X±1°		0.XXX± 0.1		scale 1:1		WITH SCREW LOCK, HARPOON & METAL BRACKET	
F	I09-0023	AS	2009/02/11	dr		GEORGE.V.J 2006/10/17		FCJ		dwg no	
G	ELXI-I-15060	AB	2013/06/25	engr		ALIAS.BABU 2013/06/25		sheet 1 of 1		size 5	
sheet index		revision sheet		chr		MITHUN.PAUL 2013/06/25		C01-8646-0742		A3	
		1		appd		BIJU.K.PAUL 2013/06/25		CUSTOMER Drawing			