

SPECIFICATIONS

Mechanical

Contact Retention Force: 1.0kgf min.
Mating force: 340gf max. per contact pair
Unmating force: 15gf min. per contact pair
Durability: 500 Cycles

Electrical

Current Rating: 3A max.
Current Voltage: 250V
Contact Resistance: 15mΩ max. initial
Dielectric Withstanding Voltage: 1000V
Insulation Resistance: 5000MΩ min.

Physical

Housing: Thermoplastic, UL 94V-0 rated, in Black Color
Contact: Copper alloy
Plating: See "ORDERING INFORMATION"
Operating Temperature: -55°C to +85°C

EQ Series
Vertical Type
2.54mm [.100"] Pitch
98 Pos.

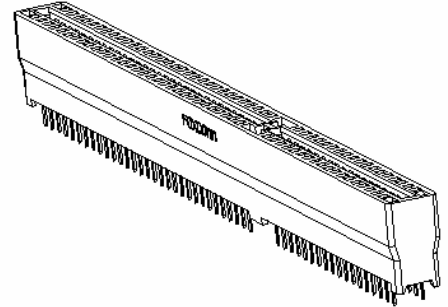

DRAWING

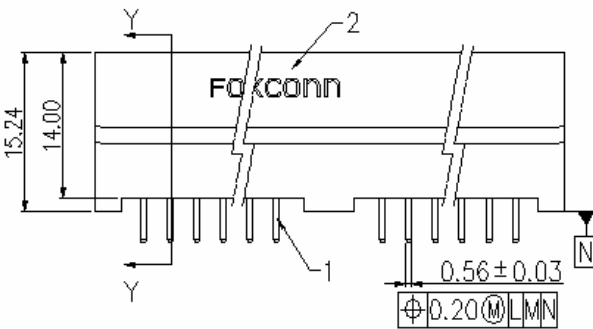
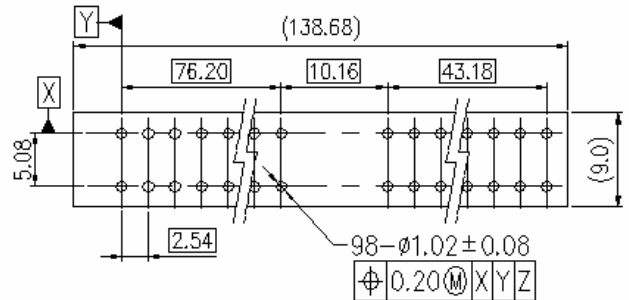
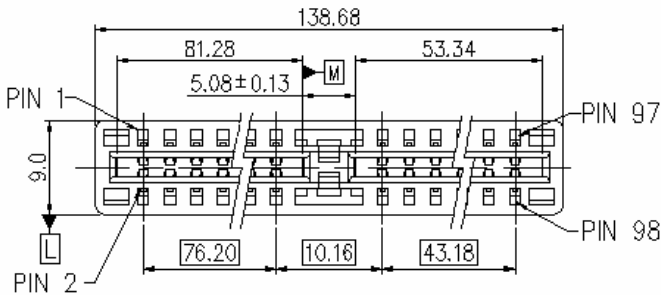

ACCEPT 1.57±0.20mm THICKNESS P.C.B.

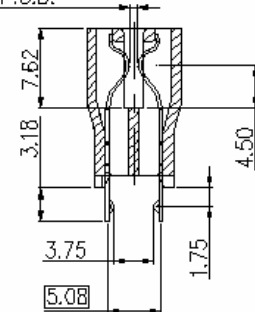

ORDERING INFORMATION

PRUDUCT NO: EQ0490* - 6F6 - **

Series Prefix: EQ
 1.27 mm Pitch
 Edge Card Conn.

Termination Type: 0
 0: Straight Type

No. of Pos.: 49
 49: 98 Pos.

Tail Length Type: 0
 0: 3.18mm

Plating Type:
 DF: Lead Free

Extension Code: 6F6

Gold Plating:
 1: Gold Flash
 3: 30u" Gold
 7: 15u" Gold

EQ04903-DCB-DF	3-6,47-50,55-58,93-96
P/N	KINK POS.