

PT00 SE (MS3120) SP00 SE wall mounting receptacle

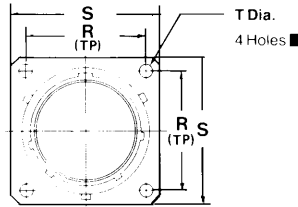

"SE" Open Wire Seal

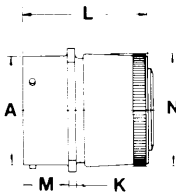

PT00SE-XX-XXX
SP00SE-XX-XXX
MS3120E-XX-XXX

TERMINATION ASSEMBLIES
"SE" (SR), MS "F" Strain Relief

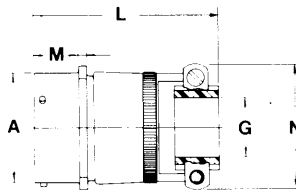

PT00SE-XX-XXX (SR)
SP00SE-XX-XXX (SR)
MS3120F-XX-XXX

"SP" Potting Boot

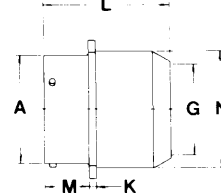

PT00SP-XX-XXX
SP00SP-XX-XXX

■ (MMC) located within .005 Dia. of (TP)

Shell Size	Receptacle Front View						Receptacle Side View					
	R (TP)		S Max.		T Dia. ±.005		A Dia. +.001 - .005	K ±.016	M +.010 - .000		P* Max. Panel Thickness	
	PT	SP	PT	SP	PT	SP		PT	SP	PT	SP	
8	.594	-	.828	-	.120	-	.473	.062	.431	-	.094	-
10	.719	.812	.954	1.141	.120	.150	.590	.062	.431	.462	.094	.125
12	.812	.938	1.047	1.266	.120	.150	.750	.062	.431	.462	.094	.125
14	.906	1.031	1.141	1.360	.120	.150	.875	.062	.431	.462	.094	.125
16	.969	1.125	1.234	1.453	.120	.150	1.000	.062	.431	.462	.094	.125
18	1.062	1.203	1.328	1.532	.120	.150	1.125	.062	.431	.462	.094	.125
20	1.156	1.297	1.453	1.688	.120	.150	1.250	.094	.556	.556	.219	.219
22	1.250	1.375	1.578	1.766	.120	.150	1.375	.094	.556	.556	.219	.219
24	1.375	1.500	1.703	1.891	.147	.150	1.500	.094	.589	.589	.219	.219

Shell Size	Class "SE", MS/"E"		Class "SE" (SR), MS/"F"			Class "SP", MS/"P"		
	L Max.	N Dia. Max.	L Max.	N Max.	G Dia.	L Max.	G Dia. Max.	N Dia. Max.
8	1.328	.560	2.422	.781	.125	-	-	-
10	1.328	.704	2.422	.844	.188	1.656	.444	.734
12	1.328	.825	2.422	.969	.312	1.656	.558	.858
14	1.328	.954	2.422	1.094	.375	1.656	.683	.984
16	1.328	1.080	2.537	1.156	.500	1.656	.808	1.110
18	1.328	1.204	2.537	1.406	.625	1.656	.909	1.234
20	1.359	1.330	2.824	1.406	.625	1.750	1.034	1.360
22	1.359	1.454	2.824	1.594	.750	1.750	1.159	1.484
24	1.422	1.580	2.900	1.688	.800	1.782	1.284	1.610

*Back panel mounting
All dimensions for reference only.