

REVISION RECORD				
REV	ECO	DESCRIPTION	DRFT	CHKD

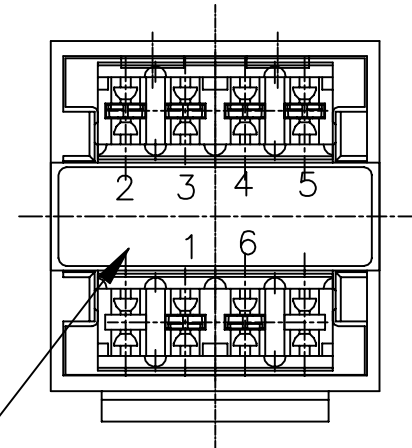
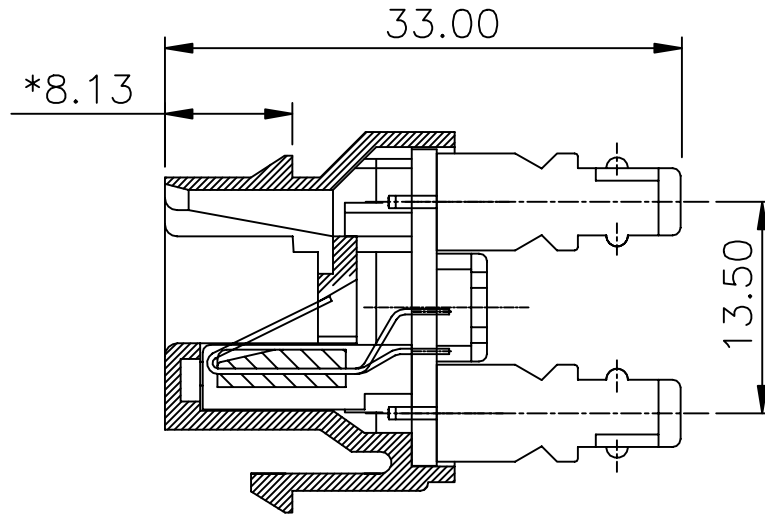
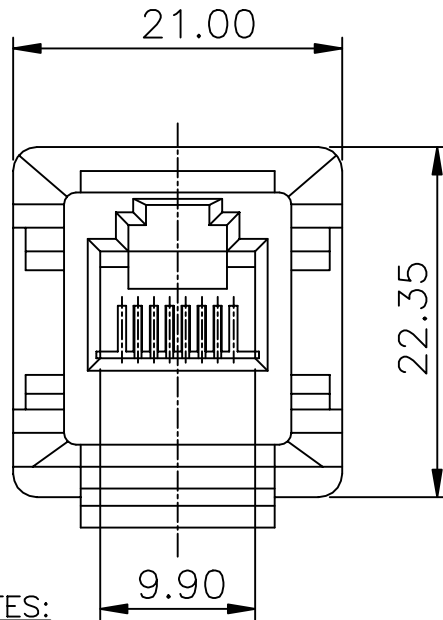

NOTES:

ELECTRICAL:

- 1. VOLTAGE RATING : 125 VAC RMS.
- 2. CURRENT RATING : 1.5 AMP.
- 3. CONTACT RESISTANCE : 100 MILLIOHMS MAX.
- 4. INSULATION RESISTANCE : 1000 MEGOHMS MIN @ 500 VDC.
- 5. DIELECTRIC STRENGTH : 750 VAC RMS 60Hz, 1MIN.

MECHANICAL:

- 1. JACK HOUSOMG MATERIAL : PC UL94V-0.
- 2. IDC HOUSING MATERIAL : PBT+15%.G.F UL94V-0.
- 3. PCB MATERIAL : FR-4,THICKNESS 1.6mm.
- 4. CONTACT MATERIAL : PHOSPHOR BRONZE T=0.35mm.
- 5. WIRE : **AWG 24~26.**
- 6. RoHS COMPLIANT
- 7. IDC TERMINAL : PHOSPHOR BRONZE AND NICKEL 50u" OR SILVER 20u" PLATED.

PART NUMBER:	PLATING
E6166-452421-L	3U
E6166-452422-L	6U
E6166-452423-L	<b>15U</b>
E6166-452424-L	30U
E6166-452425-L	<b>50U</b>

DETACHED LISTS	MM (INCH)		DFTO COKE	DATE 1/2/04*
	TOLERANCES EXCEPT AS NOTED		CHKD ZBK	DATE 2006/11/2
	MM	±	MFO	DATE
	.0 ± 0.2	±	APPVL SAMMY	DATE 2006/11/2
	.00 ± 0.15	±	MATERIAL :	
.000 ± 0.075	±	QT'Y :		
ANGLES ± 0.5		FINISH :		SCALE : 1:1
THIRD ANGLE PROJECTION				

	<b>RoHS Compliant</b>
<b>FULL RISE ELECTRONIC CO., LTD</b>	
TITLE RJ12 180° TOP ENTRY KEYSTONE (CAT.3) (IDC-ADVANCED)	
DRAWING NO. GE613075-LC	SIZE A3
/PART NO. SEE NOTE	
DO NOT SCALE DRAWING	SHEET X OF Y