



TAI-SAW TECHNOLOGY CO., LTD.

No. 3, Industrial 2nd Rd., Ping-Chen Industrial District,
Taoyuan, 324, Taiwan, R.O.C.

TEL: 886-3-4690038 FAX: 886-3-4697532

E-mail: tstsales@mail.taisaw.com Web: www.taisaw.com

Approval Sheet For Product Specification

Issued Date: Jun, 19, 2006

Product Name: SAW Filter 1575.42 MHz SMD 2.0x1.6 mm

TST Parts No.:TA0406A

Customer Parts No.: _____

| |
|---------------------|
| Company: _____ |
| Division: _____ |
| Approved by : _____ |
| Date: _____ |

Checked by: _____ Bob Chau

Approval by: _____ Francis Chen

Date: _____ 6, 19, 2006



TAI-SAW TECHNOLOGY CO., LTD.

No. 3, Industrial 2nd Rd., Ping-Chen Industrial District,
Taoyuan, 324, Taiwan, R.O.C.

TEL: 886-3-4690038 FAX: 886-3-4697532

E-mail: tstsales@mail.taisaw.com Web: www.taisaw.com

SAW Filter 1575.42 MHz for GPS

MODEL NO.: TA0406A

REV. NO.:2

A. MAXIMUM RATING:

1. Input Power Level: 10 dB_m
2. DC voltage: 5 V
3. Operating Temperature: -30°C to +85°C
4. Storage Temperature: -40°C to +95°C

RoHS Compliant
 Lead free
 Lead-free soldering

B. ELECTRICAL CHARACTERISTICS:

| Item | | Min. | Typ. | Max. |
|--|----------------------------|------|---------|------|
| Center frequency | F_c (MHz) | - | 1575.42 | - |
| Insertion loss (1574.22~1576.62 MHz) | IL (dB) | - | 1.5 | 2.2 |
| Amplitude ripple (1574.22~1576.62 MHz) | (dB) | - | 0.1 | 1.0 |
| Attenuation (Reference level from 0 dB) | | | | |
| D.C. ~ 1400 | MHz (dB) | 33.0 | 35.0 | - |
| 1400 ~ 1475 | MHz (dB) | 35.0 | 42.0 | - |
| 1475 ~ 1525 | MHz (dB) | 25.0 | 42.0 | - |
| 1625 ~ 1640 | MHz (dB) | 30.0 | 53.0 | - |
| 1640 ~ 2000 | MHz (dB) | 35.0 | 41.0 | - |
| 2000 ~ 3000 | MHz (dB) | 25.0 | 36.0 | - |
| VSWR (1574.22~1576.62 MHz) | | - | 1.15 | 2.0 |
| Source impedance | Z_s (Ω) | - | 50 | - |
| Load impedance | Z_L (Ω) | - | 50 | - |

Note1. The standard definitions is in JIS C 6703

C. OUTLINE DRAWING:

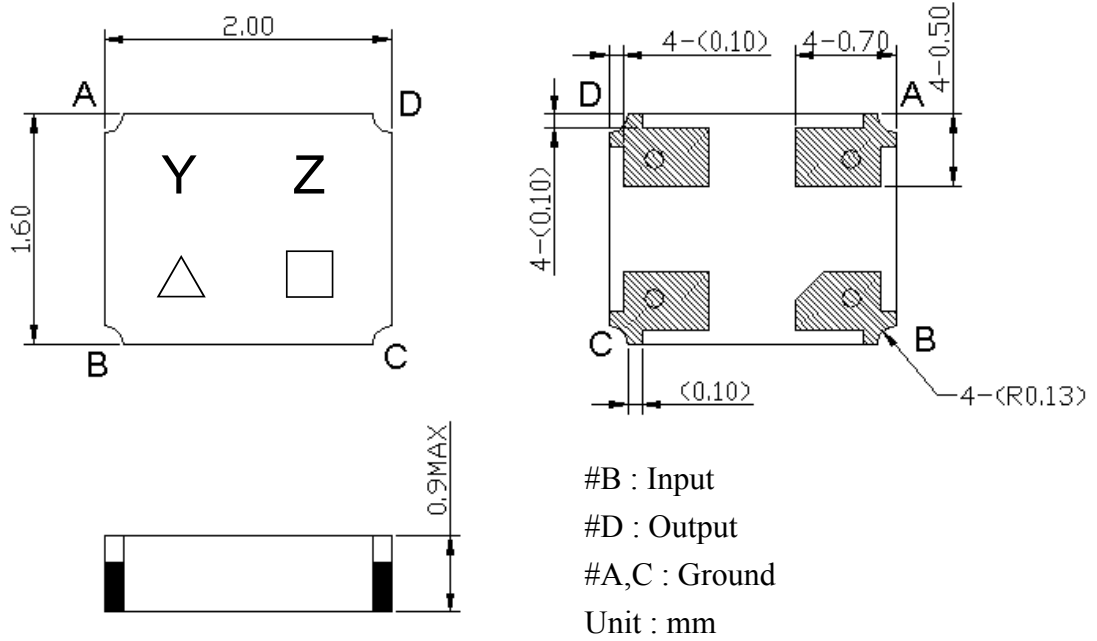

△ : Year Code (2006->6, ..., 2009->9)

□ : Date Code (Follow the table from planner each year)

D. MEASUREMENT CIRCUIT:

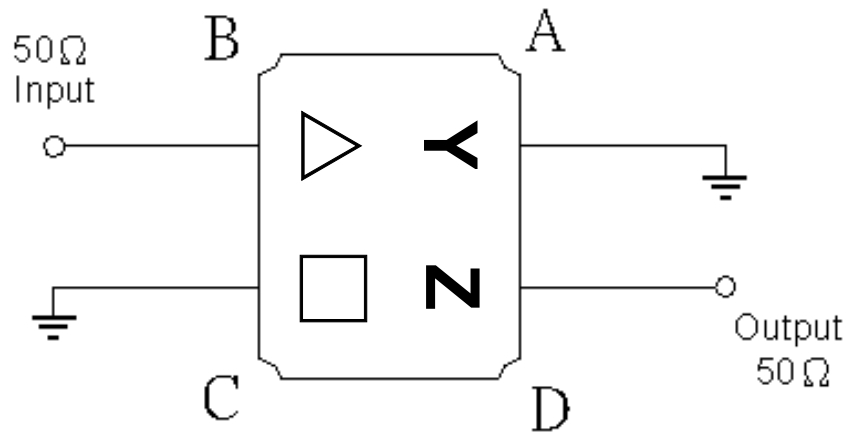

E. Frequency Characteristics : Transfer function

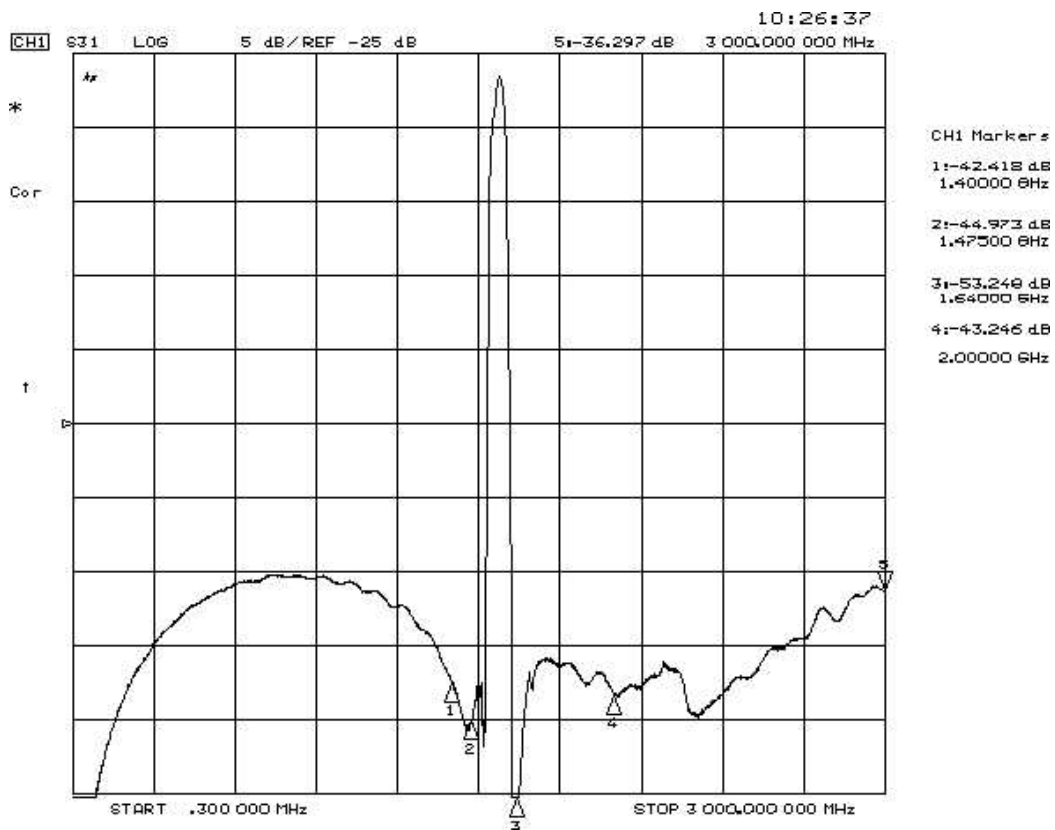
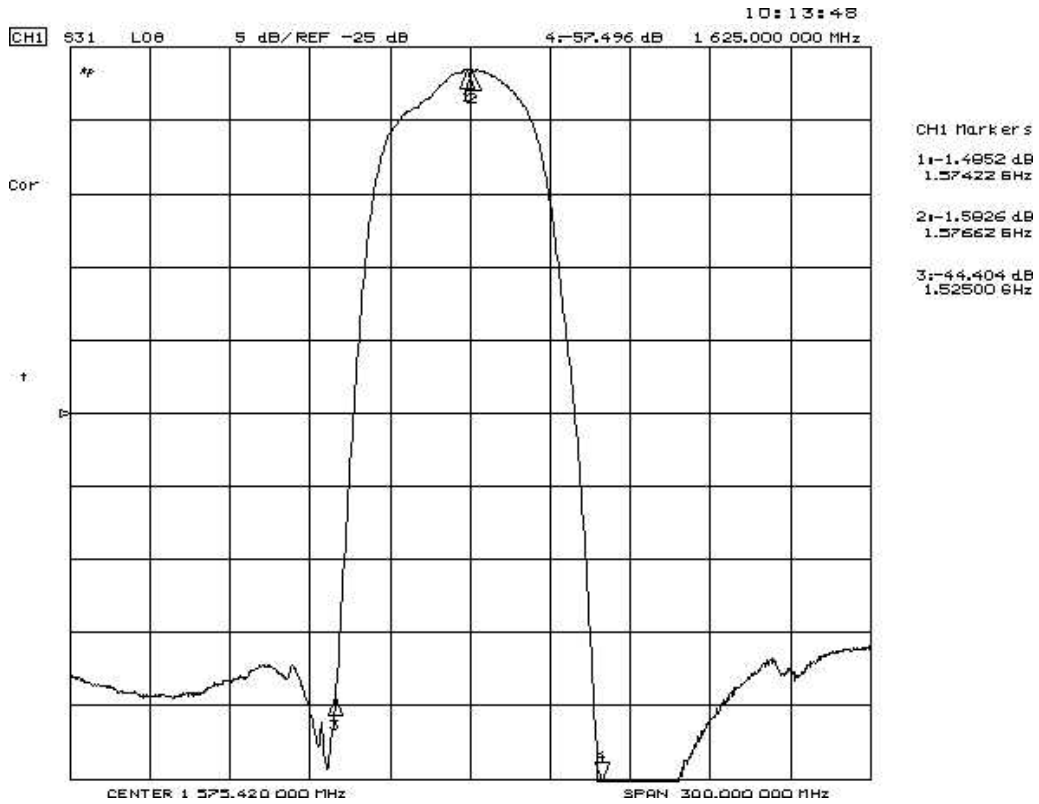

Reflections Functions :

S11 VSWR

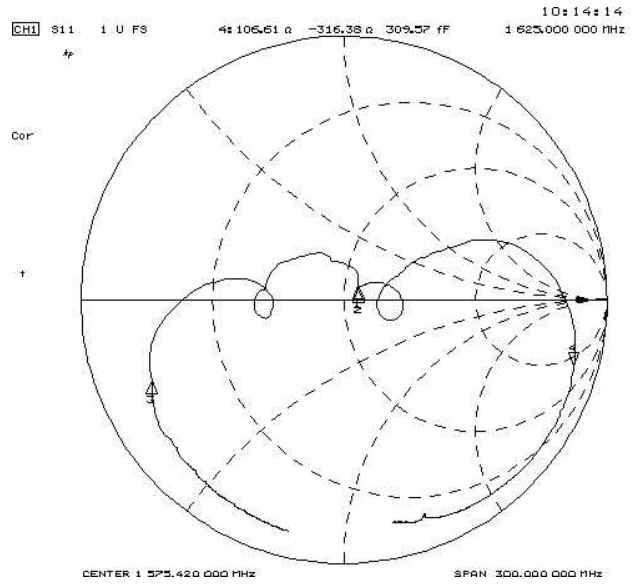
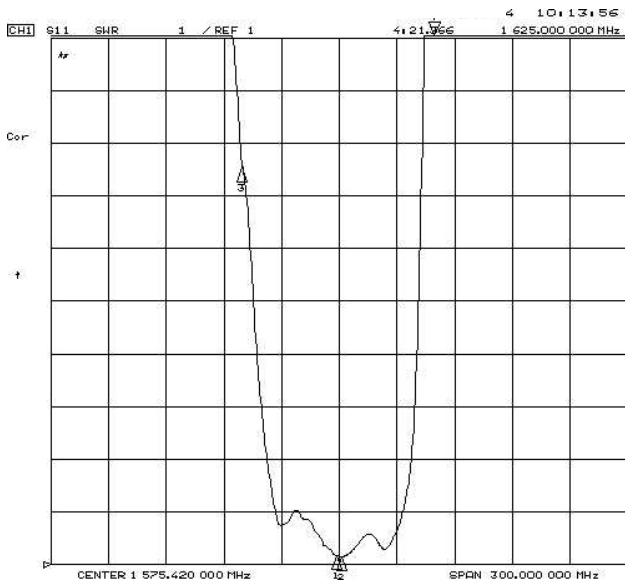

S22 VSWR

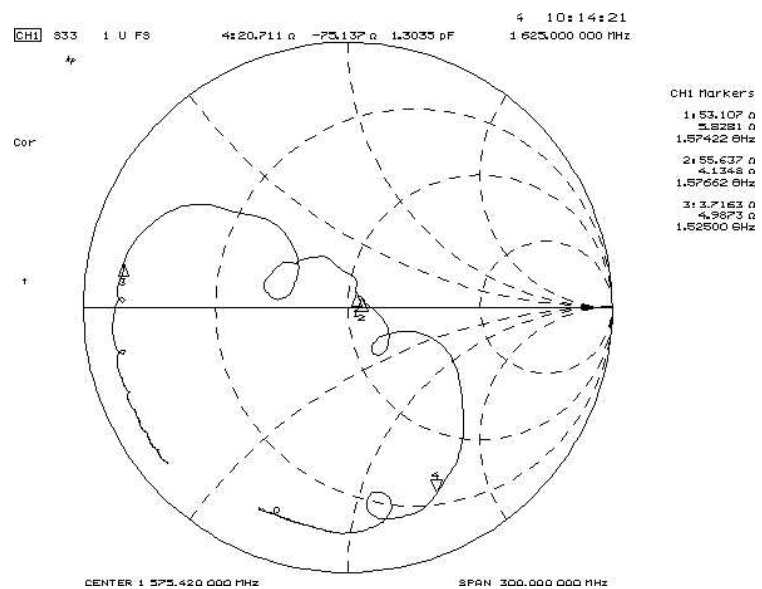
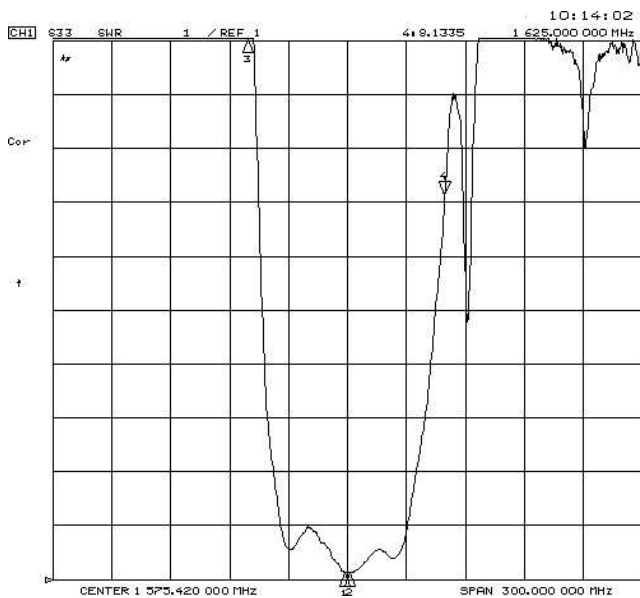

F. PACKING:

1. REEL DIMENSION

(Reel Count : 7"=2000 typ. ; 13"=10000 typ.)

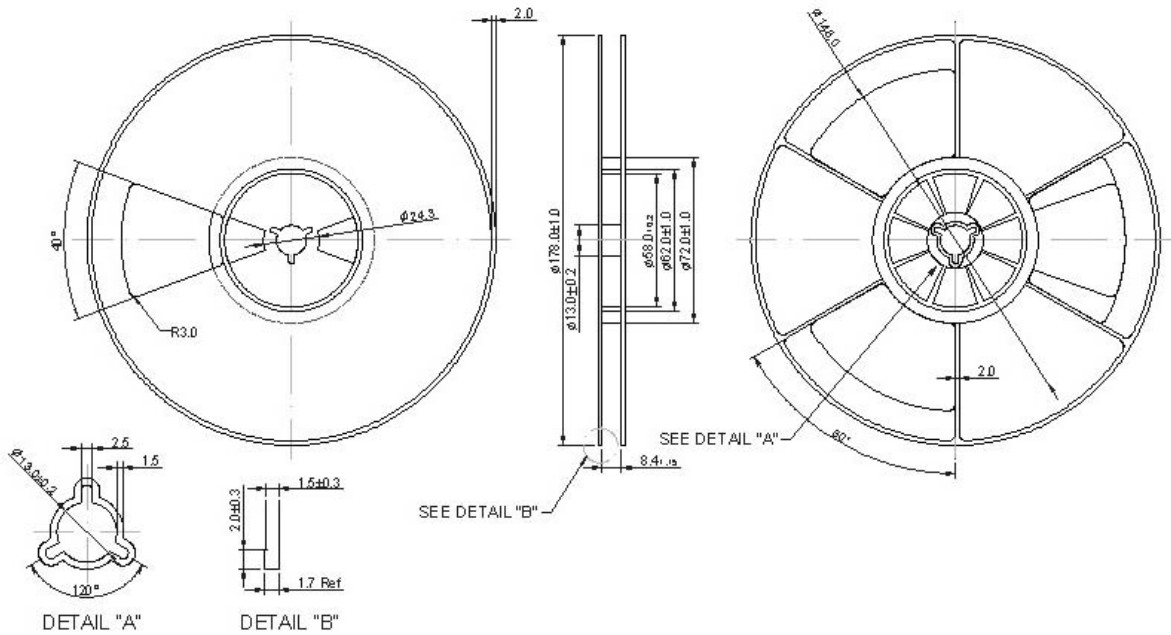

2. TAPE DIMENSION

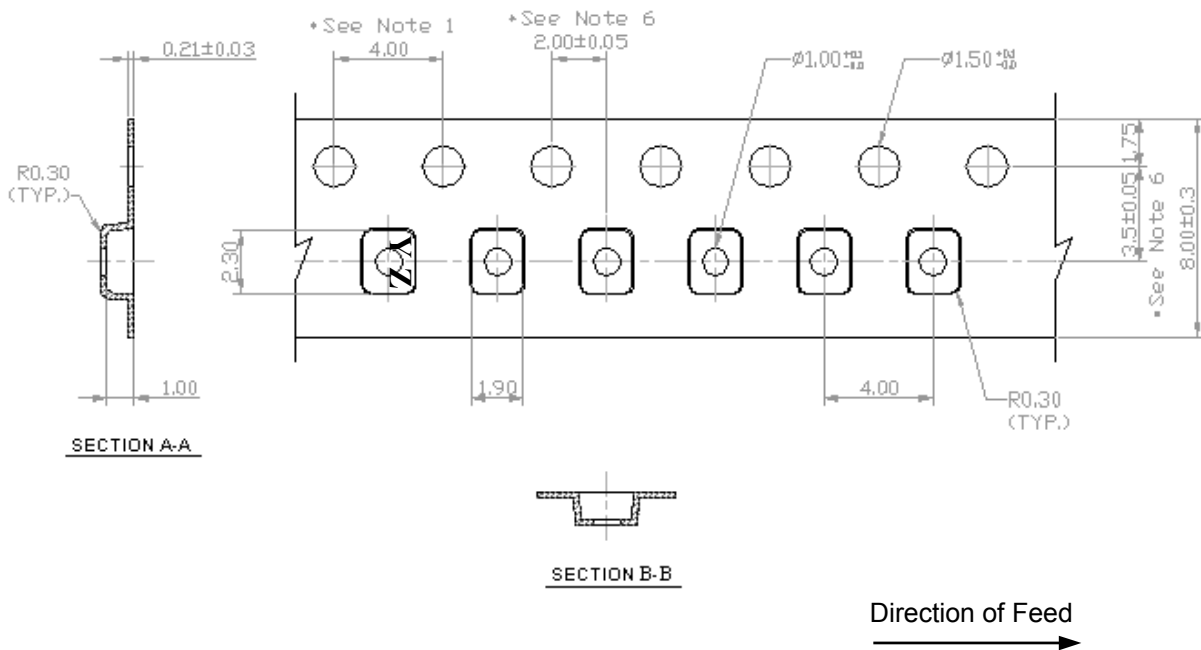

H. RECOMMENDED REFLOW PROFILE :

