

20 STERN AVE.
 SPRINGFIELD, NEW JERSEY 07081
 U.S.A.

TELEPHONE: (201) 376-2
 (212) 227-6
 FAX: (201) 376-8

PARAMETERS

2N4126
 SI PNP LP HF BJT

Description: Si PNP LP HF BJT
 Manufacturer.....
 Mil/High-Rel? (Y/N).....
 Vbr CEO..... 25
 Trans. Freq (Hz) Min..... 250M
 hfe.....
 @VCE (test) (V).....
 @Ic (A).....
 Ic Max. (A)..... 200m
 C(ob) (F).....
 Icbo Max. @Vcb Max. (A)..... 50nX
 t(on) Delay (S)..... 43nB.
 Tr Max. (s).....
 t(stor) Max. (S).....
 t(f) Max. (S).....
 Max. PD (W)..... 350m
 Derate (Amb) (W/xC)..... 2.8m
 Vbr CBO..... 25
 Oper. Temp (xC) Max..... 150u
 @ Temp (derating) test xC...
 Oper. Temp (xC) Min.....
 Pkg Style..... TO-92
 Surface Mounted (Y/N)..... N
 Pinout Equivalence Number..... 3-12

t_j - Junction Temperature . B Typical 2 It(rms) X @ Below Vcb(max)
 . T(on) = td + tr

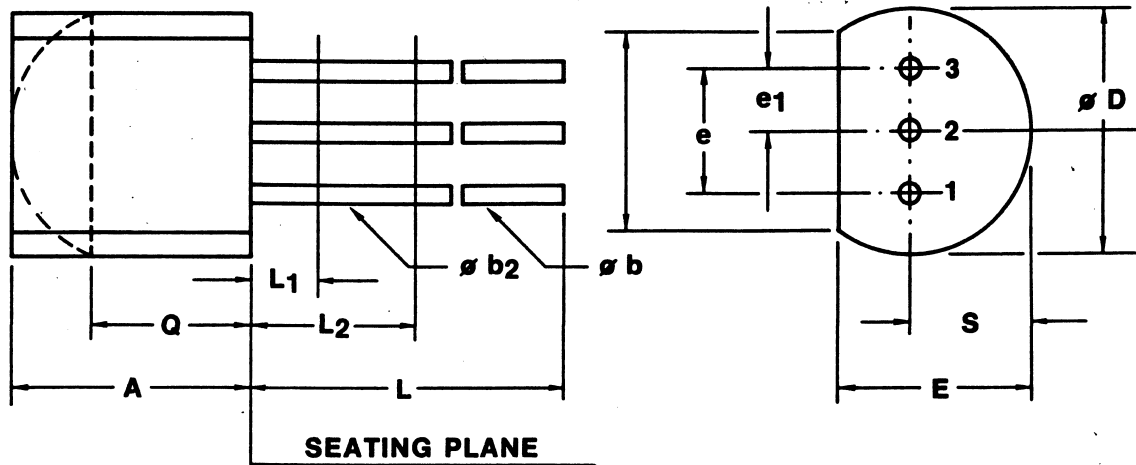

SYMBOL	INCHES		MILLIMETERS		NOTES
	MIN.	MAX.	MIN.	MAX.	
A	.170	.210	4.58	5.33	
Ob	.016	.021	.407	.533	1, 3
Ob2	.016	.019	.407	.482	3
OD	.175	.205	4.98	5.20	
E	.125	.165	3.94	4.19	
e	.095	.105	2.42	2.66	
e1	.045	.055	1.15	1.39	
j	.135		3.43		
L	.500		12.70		1, 3
L1		.050		1.27	3
L2	.250		6.35		3
Q	.115		2.93		2
S	.080	.105	2.42	2.66	

NOTES:

1. Three leads
2. Contour of the package beyond this zone is uncontrolled.
3. (Three leads) Ob2 applies between L1 and L2. Ob applies between L2 and L (12.70 mm) from seating plane. Diameter is uncontrolled in L beyond .5" (12.70 mm) from seating plane.

