

DASH NO.	M CODE	MADE FROM
----------	--------	-----------

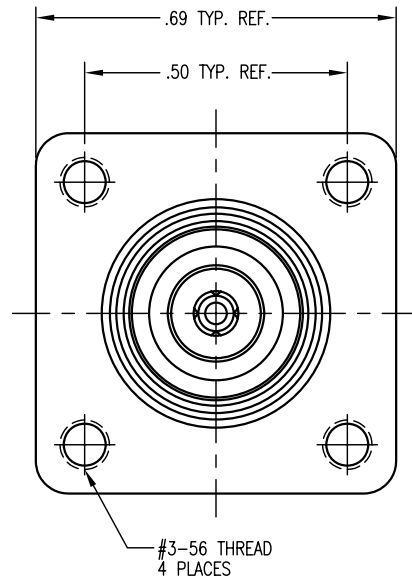
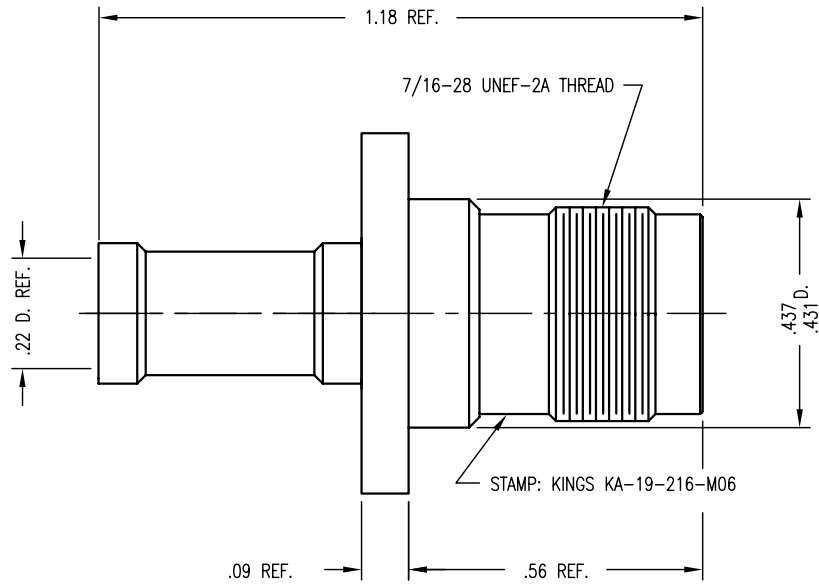

- NOTES:
- FOR USE WITH RG-142,223, & .400 CABLES.
 - FOR CABLING INSTRUCTIONS SEE CP-5401.
 - FOR CRIMPING USE DIE KTH-2061.
 - MAXIMUM PANEL THICKNESS: .125
 - INTERFACE PER MIL-STD-348, FIG. 313-2.
 - MARK PACKAGE: KINGS KA-19-216-M06
YRWK (DATE CODE)
 - MATERIALS:
K-GRIP SLEEVE: COM. BRONZE TUBE , ASTM-B-135
INSULATOR: TEFLON, ASTM-D-4894
CENTER CONTACT: BER. COPPER, ASTM-B-196
ALL OTHER METAL PARTS: BRASS, ASTM-B16
 - FINISHES:
CENTER CONTACT: HARD GOLD PLATE PER MIL-G-45204
ALL OTHER METAL PARTS: KINGS TARNISH RESISTANT NICKEL FINISH (TR-5)
 - ELECTRICAL CHARACTERISTICS:
FREQUENCY RANGE: DC TO 11 GHz
VOLTAGE RATING: 500 VRMS
NOMINAL IMPEDANCE: 50 OHMS

SDKA-19-216-M06

REVISIONS	
ISSUE	CHANGES
0	ER 28661 MJB 02/26/87
1	CN 29713 D AJ 04/13/88
2	CN 31044 C JCA 08/08/89
D	REVISED PER ER19737 GGR 11/06/2009

KA19216S

CUSTOMER SALES DRAWING

SCALE	4:1
APPROX SURFACE AREA	
USED ON	
REF:	

JK, PNL, TNC

DRAWN	MJB	DATE	02/26/87
DESIGN	CT	DATE	02/27/87
APPR.	VLS	DATE	02/27/87

KINGS
by WINCHESTER
ELECTRONICS

Winchester Electronics
62 Barnes Industrial
Road North
Wallingford, CT 06492

SDKA-19-216-M06