

630-031 Composite Thru-Box, Panel and Bulkhead Universal Environmental Adapter

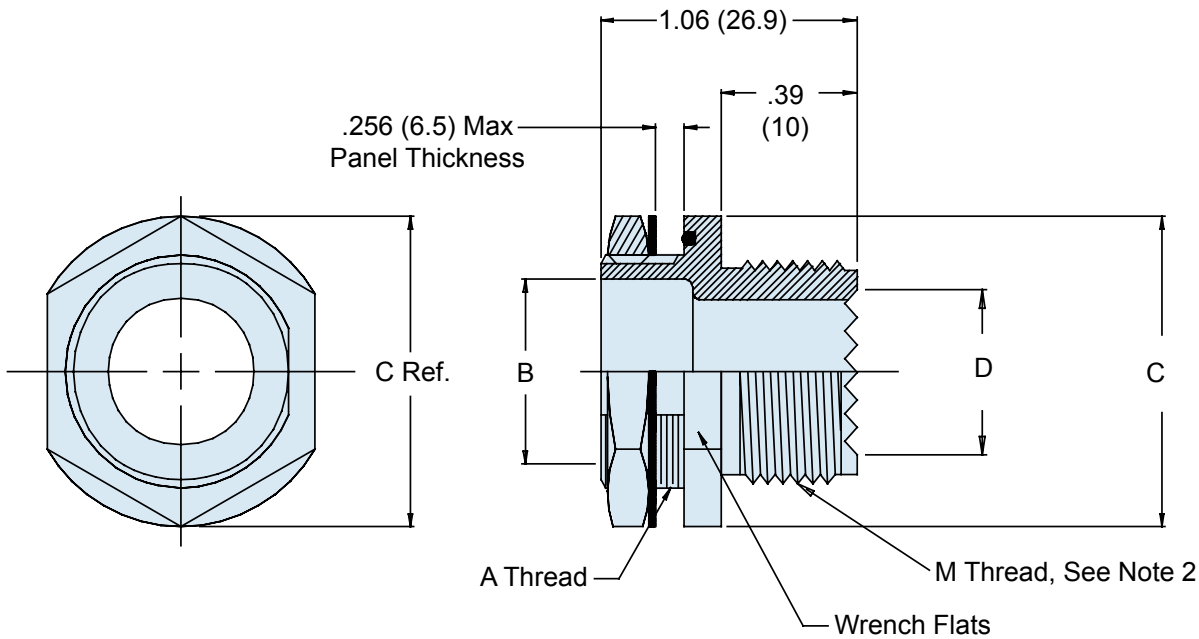
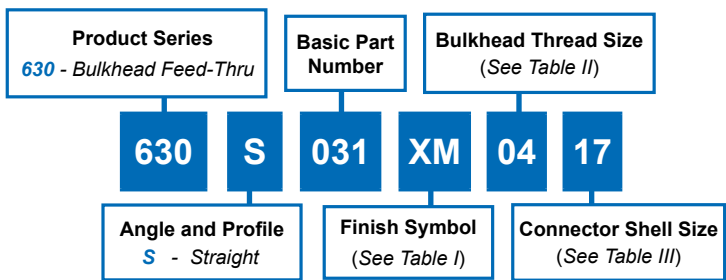

E

- APPLICATION NOTES**
1. Metric dimensions (mm) are in parentheses and are for reference only.
 2. MIL-DTL-38999 Series 3 & 4 Accessory Interface, Glenair Code H.

630-031
Composite Thru-Box, Panel and Bulkhead
Universal Environmental Adapter



Composite
 Junction
 Boxes

TABLE I	
Symbol	Finish Description
XM	2000 Hour Corrosion Resistant Electroless Nickel
XMT	2000 Hour Corrosion Resistant Ni-PTFE, Nickel-Fluorocarbon Polymer. <i>1000 Hour Grey™</i>
XW	2000 Hour Corrosion Resistant Cadmium/Olive Drab over Electroless Nickel

TABLE II: BULKHEAD THREAD SIZE						
Dash No.	A Thread ISO Metric	B Dia. Min.	C Max.	Max Entry Table 3		
01	M 16 x 1.5-6g	.394 (10.0)	1.070 (27.2)	11		
02	M 20 x 1.5-6g	.551 (14.0)	1.200 (30.5)	13		
03	M 27 x 2.0-6g	.866 (22.0)	1.510 (38.4)	21		
04	M 36 x 2.0-6g	1.181 (30.0)	2.010 (51.1)	25		

TABLE III: CONNECTOR SHELL SIZE			
Shell Size	M Thread ISO Metric	D Min	
09	M 12 x 1.0-6g	.250	(6.4)
11	M 15 x 1.0-6g	.375	(9.5)
13	M 18 x 1.0-6g	.500	(12.7)
15	M 22 x 1.0-6g	.625	(15.9)
17	M 25 x 1.0-6g	.750	(19.1)
19	M 28 x 1.0-6g	.812	(20.6)
21	M 31 x 1.0-6g	.938	(23.8)
23	M 34 x 1.0-6g	1.062	(27.0)
25	M 37 x 1.0-6g	1.188	(30.2)

E