

# Stewart Connector

http://www.stewartconnector.com

11118 Susquehanna Trail South  
 Glen Rock, PA 17327-9199  
 (717) 235-7512 Fax: (717) 235-7954

| REV. | REVISION CHANGES             | ECN  |
|------|------------------------------|------|
| A1   | CORRECTED TOP VIEW GEOMETRY. | 5973 |
|      |                              |      |
|      |                              |      |
|      |                              |      |

PART NO. SS-7388H11S-PG4-AC (30uIN GOLD)  
 PART NO. SS-7388H11S-PG4-AC-50 (50uIN GOLD)

EIGHT CONTACT, EIGHT POSITION  
 SHIELDED STACKED HARMONICA JACK  
 2 PORTS (1 ON 1)

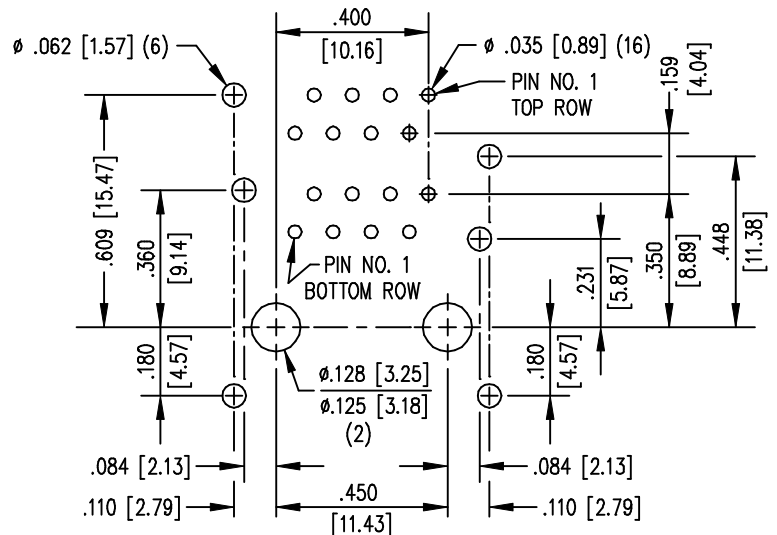
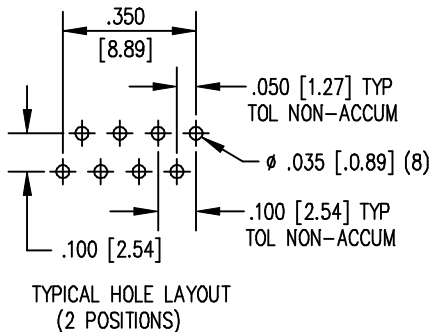
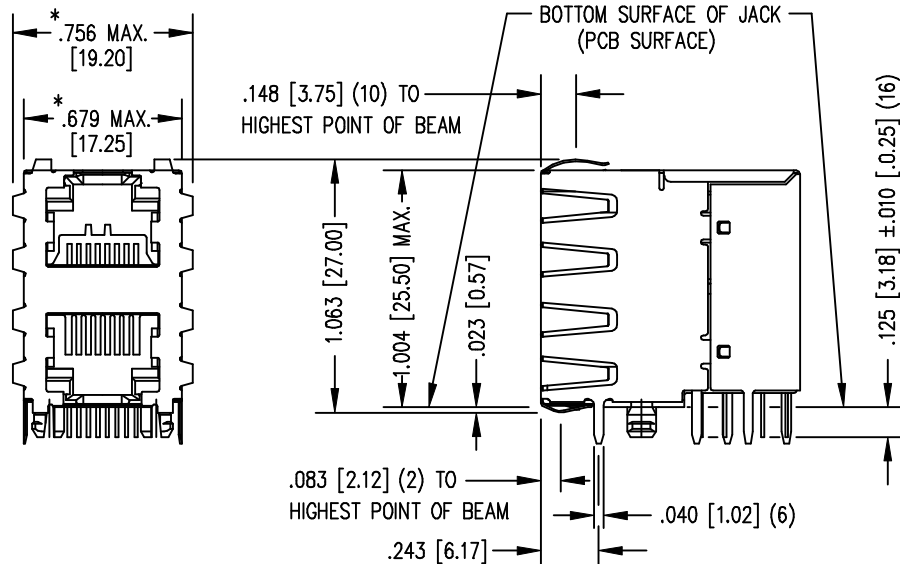
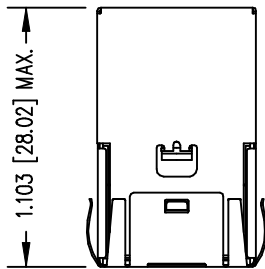

- NOTES:
- TOLERANCES COMPLY WITH F.C.C. DIMENSION REQUIREMENTS.
  - DIMENSIONS SHOWN WITH "\*" TO BE CENTRAL ABOUT CENTER LINE.
  - DIMENSIONS SHOWN ARE SUBJECT TO CHANGE WITHOUT NOTICE.

AVAILABLE WITH:  
 LOADED 1 - 8 CONTACTS

SHEET 1 OF 2

P.C.B. RECOMMENDED HOLE LAYOUT  
 SEEN FROM COMPONENT SIDE  
 TOLERANCE ±.003 [0.08] UNLESS OTHERWISE SPECIFIED

THIS DRAWING AND THE SUBJECT MATTER SHOWN THEREON ARE CONFIDENTIAL AND THE PROPRIETARY PROPERTY OF STEWART CONNECTOR ("SCS") AND SHALL NOT BE REPRODUCED, COPIED OR USED IN ANY MANNER WITHOUT PRIOR WRITTEN CONSENT OF "SCS". THE SUBJECT MATTER MAY BE PATENTED OR A PATENT MAY BE PENDING. © SCS

THIRD ANGLE PROJECTION

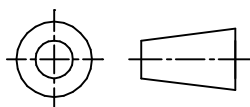

|   |                  |                             |
|---|------------------|-----------------------------|
| DRN BY: T. R. MECKLEY                                   | DATE 1-13-98     | ORIGINAL PROPOSAL DRAWING - |
| CKD BY: L. K. E.  | DATE 1-14-98     | ENR NUMBER -                |
| APPD BY: T. R. MECKLEY                                  | DATE 1-14-98     | PROJECT NO. -               |
| UNLESS OTHERWISE SPECIFIED TOLERANCES ARE ±.005 [±0.13] | DWG NO. CT730056 | REV. A1                     |

# Stewart Connector

11118 Susquehanna Trail South  
 Glen Rock, PA 17327-9199  
 (717) 235-7512 Fax: (717) 235-7954

http://www.stewartconnector.com

| REV. | REVISION CHANGES             | ECN  |
|------|------------------------------|------|
| A1   | CORRECTED TOP VIEW GEOMETRY. | 5973 |
|      |                              |      |
|      |                              |      |
|      |                              |      |

PART NO. SS-7388H11S-PG4-AC (30uIN GOLD)  
 PART NO. SS-7388H11S-PG4-AC-50 (50uIN GOLD)

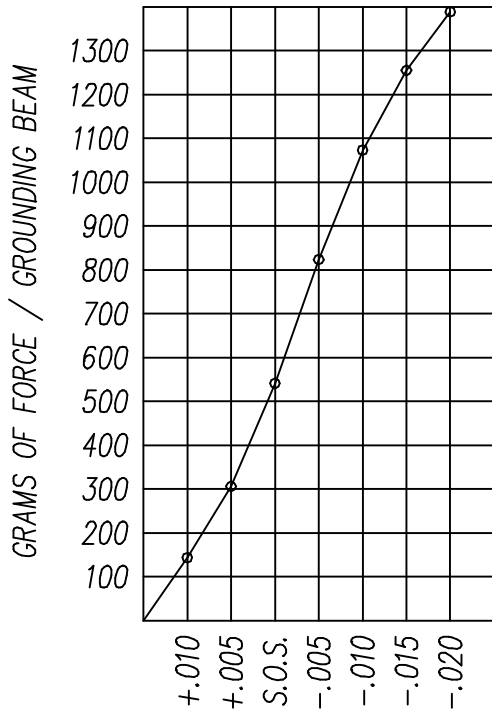

PANEL GROUNDING BEAM DEFLECTION  
 TOP AND SIDE BEAMS  
 S.O.S. = SUGGESTED OPENING SIZE

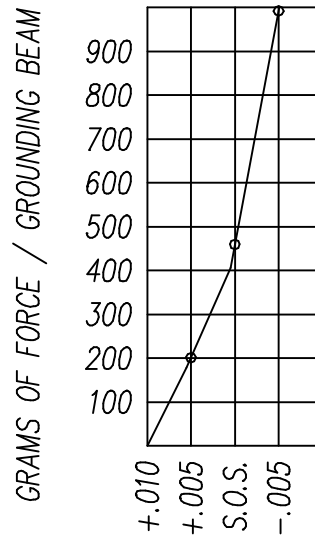

PANEL GROUNDING BEAM DEFLECTION  
 BOTTOM BEAMS ONLY  
 S.O.S. = SUGGESTED OPENING SIZE

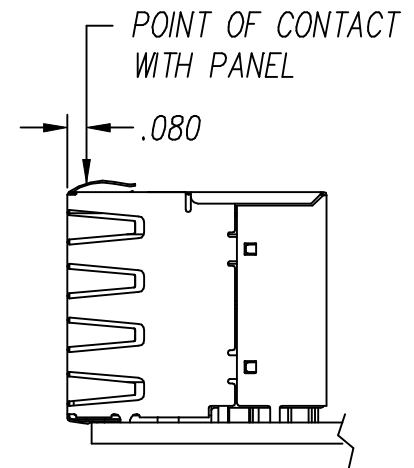

THE SUGGESTED PANEL OPENING IS INTENDED TO GIVE THE USER THE ABILITY TO HAVE REASONABLE JACK / PANEL CLEARANCES YET MAINTAIN RELIABLE GROUNDING CAPABILITY. THESE VARIABLES CAN BE ADJUSTED IN EITHER DIRECTION BUT MAY CARRY SOME CONSEQUENCES IN THE FORM OF LOWER MATING FORCES OR TIGHTER ASSEMBLY TOLERANCES. FORCE VALUES ON THE GRAPH(S) ARE GENERAL AVERAGES TAKEN AT A POINT OF CONTACT SHOWN ABOVE. THE SUGGESTED PANEL OPENING INCLUDES APPROXIMATELY .020 CLEARANCE ON THE TOP AND SIDES, WITH .015 CLEARANCE ON THE BOTTOM.

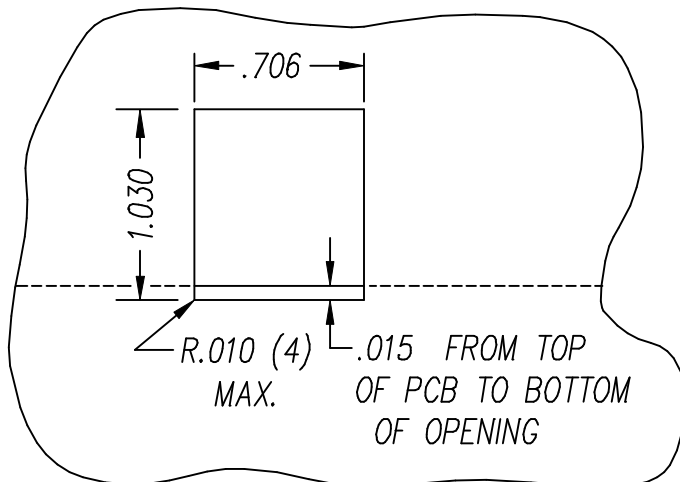

SUGGESTED PANEL OPENING  
 (N.T.S.)

SHEET 2 OF 2

THIS DRAWING AND THE SUBJECT MATTER SHOWN THEREON ARE CONFIDENTIAL AND THE PROPRIETARY PROPERTY OF STEWART CONNECTOR ("SCS") AND SHALL NOT BE REPRODUCED, COPIED OR USED IN ANY MANNER WITHOUT PRIOR WRITTEN CONSENT OF "SCS". THE SUBJECT MATTER MAY BE PATENTED OR A PATENT MAY BE PENDING. © SCS

THIRD ANGLE PROJECTION

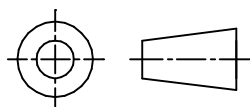

DRN BY: T. R. MECKLEY

DATE 1-13-98

ORIGINAL PROPOSAL DRAWING -

CKD BY: L. K. E.

DATE 1-14-98

ENR NUMBER -

APPD BY: T. R. MECKLEY

DATE 1-14-98

PROJECT NO. -

UNLESS OTHERWISE SPECIFIED TOLERANCES ARE ±.005 [±0.13]

DWG NO. CT730056

REV. A1