

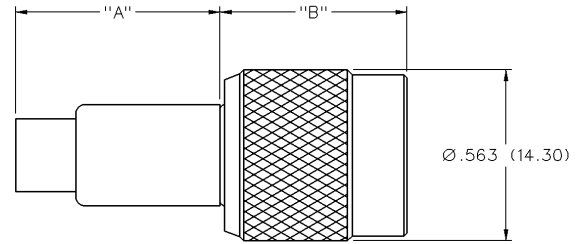

INCHES (MILLIMETERS)
CUSTOMER DRAWINGS AVAILABLE UPON REQUEST

TNC Straight Crimp Type Plug - Solder or Crimp Contact - 3 Piece



PART NUMBER	CABLE TYPE	"A"	"B"	CONTACT I.D.	BODY I.D.	FERRULE I.D.
CPMC-TNC-13	RG-142, 223, 400, 55	.520 (13.20)	.595 (15.11)	.044 (1.12)	.126 (3.20)	.220 (5.59)

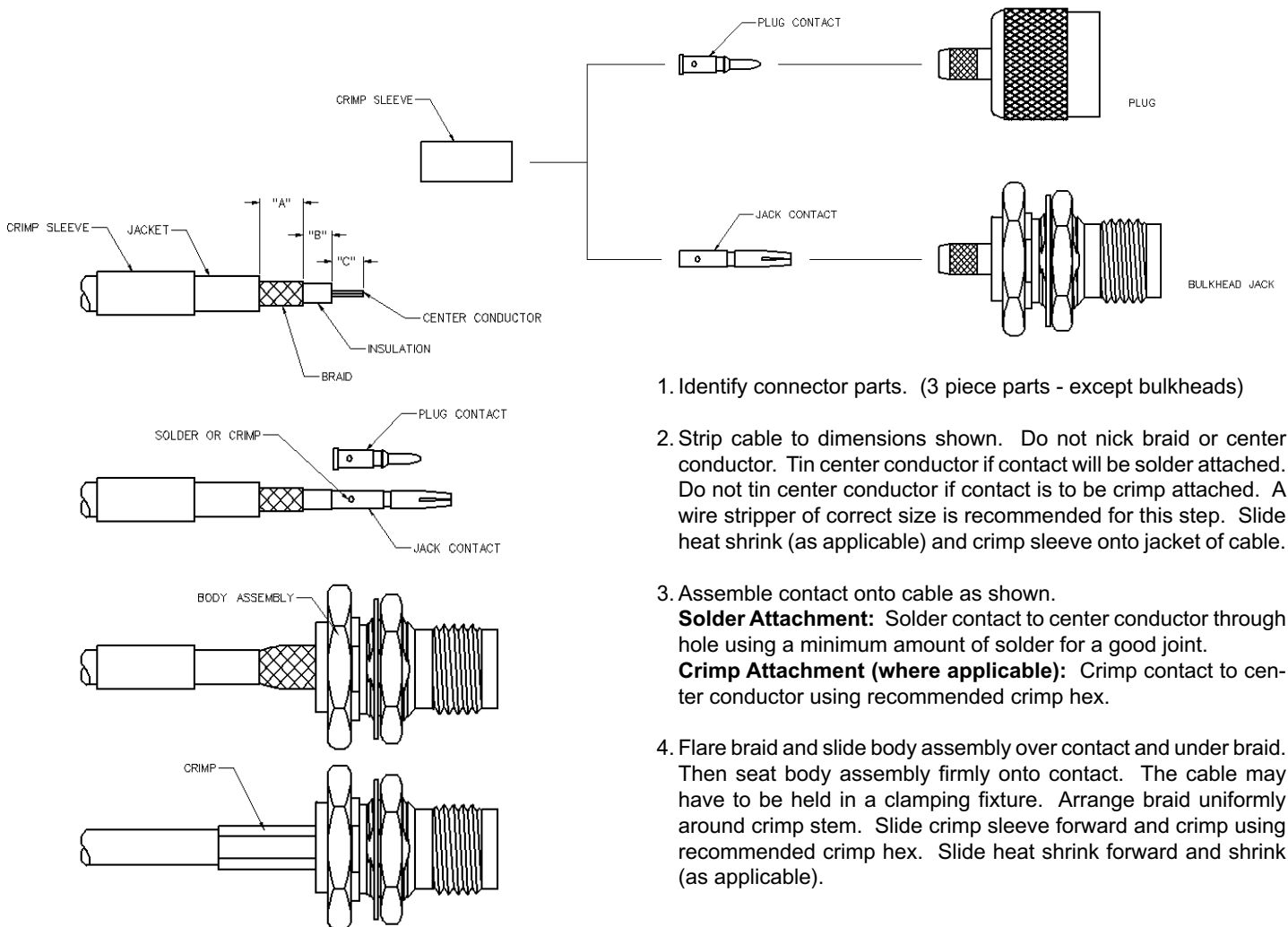

1. Identify connector parts. (3 piece parts - except bulkheads)
2. Strip cable to dimensions shown. Do not nick braid or center conductor. Tin center conductor if contact will be solder attached. Do not tin center conductor if contact is to be crimp attached. A wire stripper of correct size is recommended for this step. Slide heat shrink (as applicable) and crimp sleeve onto jacket of cable.
3. Assemble contact onto cable as shown.
Solder Attachment: Solder contact to center conductor through hole using a minimum amount of solder for a good joint.
Crimp Attachment (where applicable): Crimp contact to center conductor using recommended crimp hex.
4. Flare braid and slide body assembly over contact and under braid. Then seat body assembly firmly onto contact. The cable may have to be held in a clamping fixture. Arrange braid uniformly around crimp stem. Slide crimp sleeve forward and crimp using recommended crimp hex. Slide heat shrink forward and shrink (as applicable).

Part Number	Cable	Strip Dimensions			Crimp Sleeve Hex	Contact Crimp Hex	Recommended Crimp Tool
		"A"	"B"	"C"			
CPMC-TNC-13	RG-55, 142	.315 (8.00)	.118 (3.00)	.157 (4.00)	.213 (5.41)	.060 (1.52)	24-304P

TNC Connectors

Specifications



INCHES (MILLIMETERS)
CUSTOMER DRAWINGS AVAILABLE UPON REQUEST

The TNC connector is a threaded version of the BNC mating interface. All contacts are captivated for ruggedness. The TNC is a commercial quality connector that provides additional retention for shock and vibration applications. The TNC connector intermates with all standard 50 Ohm TNC connectors.

Specifications*

Electrical Characteristics

Impedance: 50 Ohm nominal (except where noted)
Frequency range: 0-11 GHz
Working voltage: 500 volts RMS at sea level
Dielectric withstanding voltage: 1500 volts RMS at sea level
Corona level: 375 volts minimum at 70,000 feet
Contact resistance: Outer - 0.2 milliohms maximum
Center - 2.1 milliohms maximum
Insulation resistance: 5000 megohms minimum

Environmental Characteristics

Recommended temperature range: -55°C to +85°C
Moisture Resistance: MIL-STD-202

Mechanical Characteristics

Durability: 500 cycles
Cable retention: 20 lbs., RG-58 C/U cable

Materials

Body and coupling nut: Zinc or brass
Contact: Beryllium copper, phosphor bronze or brass
Crimp Sleeve: Brass
Insulator: Teflon®, TPX or Delrin®
Hardware: Brass
Plating: Body - Nickel
Crimp sleeve - Nickel
Hardware - Nickel
Contact - Gold

* These values are typical and may not apply to all connectors.