

TOLERANCE UNLESS SPECIFIED = .XXX = +/- .005 .XX = +/- .015 FRACTIONS = +/- .032

VPP28-360.DC2

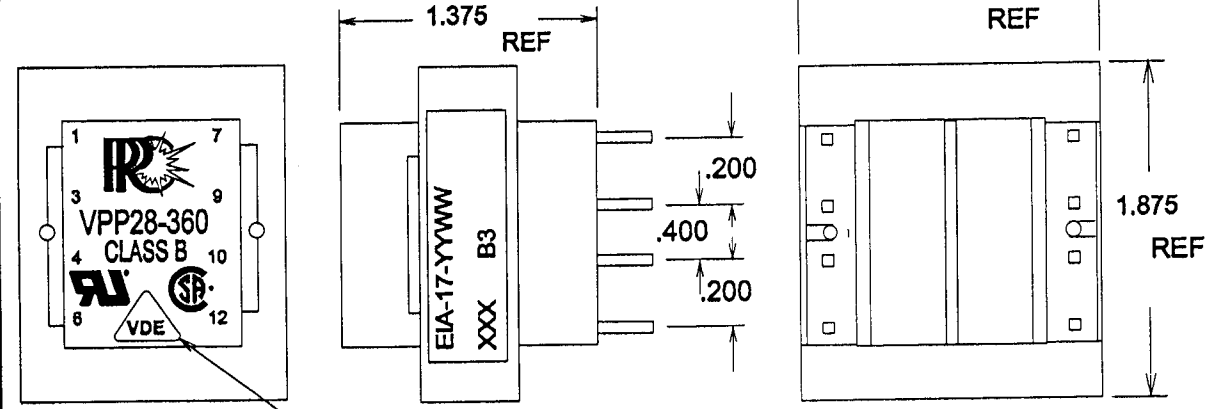

ALL MANUFACTURING SITES USE THIS MARK

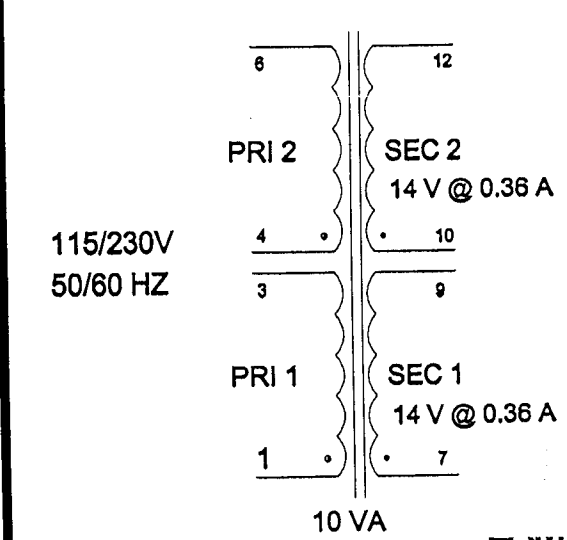

PC PINS .036 SQ

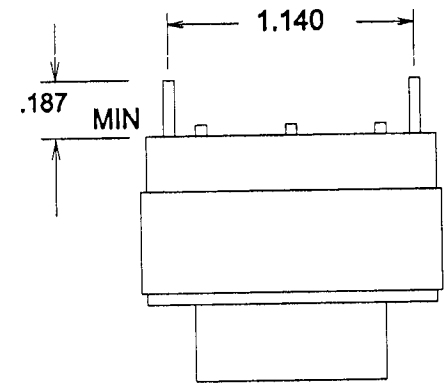

PRODUCTION TESTS

TURNS RATIO = 100%		
DC RESISTANCE IN OHMS	1-3 =	182 NOM
	4-6 =	220 NOM
	7-9 =	5.8 NOM
	10-12 =	6.8 NOM

MAX EXCITATION CURRENT = 20 MA
 APPLY 230V 60HZ 1-6 (3+4)
 PRI WDGS 114.5 TO 115.5 V
 SEC WDGS 18.2 TO 19.1 V

HIPOT: 4000V P-S
 4000V P,S, TO CORE
 600V P-P, S-S

CONTINUITY = PRI'S 100% IN FINAL
 IMPREGNATION NOTES: PREHEAT 2 HRS
 PINS TO BE FREE OF IMPREGNATION

FINAL ASSEMBLY NOTES

METHOD 1 X 1
 LEAVE OFF LAST "I" PCS

MARKING SEE LABEL DETAIL ABOVE
 APPLY PART NO. LABEL, AFTER IMPREGNATION

 PART NO.: VPP28-360