

Dimensions

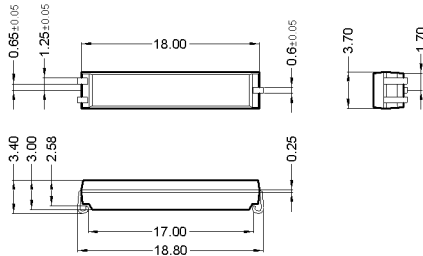

Soldering type

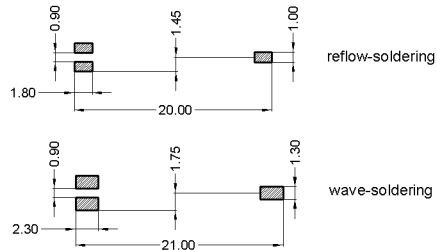

pin code / Marking
 Sensibility and DateCode EN60062

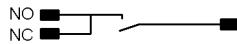

unspecified tolerances according to DIN ISO 2768-m
 nicht spezifizierte Toleranzen nach DIN ISO 2768-m

Tape and Reel Packaging (IEC 60286-3)

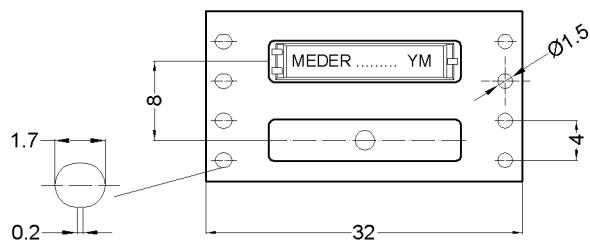

Magnetic properties	Conditions	Min	Typ	Max	Unit
Pull-In	at 20 °C	15		35	
Test equipment		KMS-11			

Contact data 66/3	Conditions	Min	Typ	Max	Unit
Contact-No.		66/3			
Contact-form		A			
Contact rating	Any DC combination of V & A not to exceed their individual max.'s			10	W
Switching voltage	DC or Peak AC			200	V
Switching current	DC or Peak AC			0,5	A
Contact resistance static	Measured with 40% overdrive Start Value			100	mOhm
Breakdown voltage (< 20 AT)	according to IEC 255-5	250			VDC

Special Product Data	Conditions	Min	Typ	Max	Unit
Housing material		epoxy resin			

Environmental data	Conditions	Min	Typ	Max	Unit
Shock	1/2 sine wave duration 11ms			30	g
Vibration	from 10 - 2000 Hz			20	g
Operating temperature		-20		130	°C
Storage temperature		-35		130	°C
Washability		fully sealed			

General data	Conditions	Min	Typ	Max	Unit
Customer / Customer number		Rademacher			