

Panasonic

www.DataSheet4U.com

Operating Instructions

Digital Cordless Phone

Model No. **KX-TG7200HK**
KX-TG7202HK



KX-TG7200

This unit is Caller ID compatible. To display the caller's phone number, you must subscribe to Caller ID service.

Charge the batteries for about 7 hours before initial use.

Please read these operating instructions before using the unit and save them for future reference.

www.DataSheet4U.com

Preparation

Introduction	3
Accessory information	4
Important information	5
Controls	7
Displays	8
Connections	8
Battery installation and replacement	9
Battery charge	10
Turning the power on/off	11
Setting up the unit before use	11

Making/Answering Calls

Making calls	13
Answering calls	13
Useful features during a call	14

Phonebook

Handset phonebook	16
-----------------------------	----

Handset Settings

Handset settings	17
----------------------------	----

Base Unit Settings

Base unit settings	18
------------------------------	----

Caller ID Service

Using Caller ID service	19
Caller list	19
Voice mail service	20

Multi-unit Operation

Operating additional units	21
Registering a handset to the base unit	21
Intercom between handsets	22
Transferring calls between handsets	22

Useful Information

Character entry	24
Error messages	26
Troubleshooting	26
Specifications	29

Index

Index	30
-----------------	----

Introduction

Thank you for purchasing a new Panasonic digital cordless phone.

www.DataSheet4U.com
For your future reference

Keep original receipt and guarantee card to assist with any repair under warranty.

Serial No. (found on the bottom of the base unit)

Date of purchase

Name and address of dealer

Note:

- In the event of problems, you should contact your equipment supplier in the first instance.

Your phone

KX-TG7200



KX-TG7202

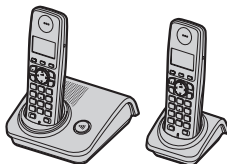

Accessory information

Supplied accessories

No.	Accessory items	Quantity	
		KX-TG7200	KX-TG7202
①	AC adaptor for base unit (Part No. PQLV207E)	1	1
②	Telephone line cord	2	2
③	Rechargeable batteries AAA (R03) size (Part No. HHR-55AAAB)	2	4
④	Handset cover* ¹	1	2
⑤	Charger (Part No. PQLV30055Z)	—	1
⑥	AC adaptor for charger (Part No. PQLV209E)	—	1

*1 The handset cover comes attached to the handset.

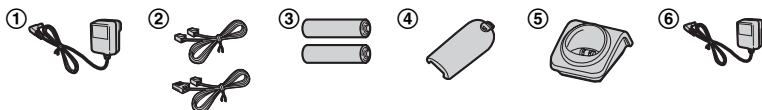

Additional/replacement accessories

Please contact your nearest Panasonic dealer for sales information.

No.	Model No.	Description
①	KX-TGA721HM	Additional Digital Cordless Handset
②	KX-A272	DECT repeater

Note:

- When replacing the batteries, use only 2 rechargeable AAA (R03) size nickel metal hydride (Ni-MH) batteries. We recommend using Panasonic rechargeable batteries (Model No. HHR-4EPT).
- Replacement batteries may have a different capacity from that of the supplied batteries.

Important information

General

www.DataSheet4U.com

- Use only the AC adaptor supplied with this product, noted on page 4.
- Do not connect the AC adaptor to any AC outlet other than a standard 220–240 V AC outlet.
- This product is unable to make calls when:
 - the portable handset battery(ies) need recharging or have failed.
 - there is a power failure.
 - the key lock feature is turned on.
- Do not open the base unit, charger, or handset other than to replace the battery(ies).
- Consult the manufacturer of any personal medical devices, such as pacemakers or hearing aids, to determine if they are adequately shielded from external RF (radio frequency) energy. (The product operates in the frequency range of 1.88 GHz to 1.90 GHz, and the power output is 250 mW (max.)) Do not use the product in health care facilities if any regulations posted in the area instruct you not to do so. Hospitals or health care facilities may be using equipment that could be sensitive to external RF energy.
- Care should be taken that objects do not fall onto, and liquids are not spilled into, the product. Do not subject this product to excessive smoke, dust, mechanical vibration or shock.

Environment

- Do not use this product near water.
- This product should be kept away from heat sources such as radiators, cookers, etc. It should also not be

placed in rooms where the temperature is less than 5 °C or greater than 40 °C.

Warning:

- To prevent the risk of electrical shock, do not expose this product to rain or any other type of moisture.
- Unplug this product from power outlets if it emits smoke, an abnormal smell, or makes unusual noise. These conditions can cause fire or electric shock. Confirm that smoke has stopped emitting and contact an authorised service centre.
- Do not spill liquids (detergents, cleansers, etc.) onto the telephone line cord plug, or allow it to become wet at all. This may cause a fire. If the telephone line cord plug becomes wet, immediately pull it from the telephone wall jack, and do not use.
- Do not place or use this product near automatically controlled devices such as automatic doors and fire alarms. Radio waves emitted from this product may cause such devices to malfunction resulting in an accident.
- Regularly remove any dust, etc. from the AC adaptor/power plug by pulling it from the power outlet, then wiping with a dry cloth. Accumulated dust may cause an insulation defect from moisture, etc. resulting in a fire.
- Do not damage the power cord/plug. This may cause a short circuit, electric shock, and/or fire.
- Do not touch the plug with wet hands.
- The AC adaptor is used as the main disconnect device. Ensure that the AC outlet is installed near the product and is easily accessible.

Battery caution

- We recommend using the battery(ies) noted on page 4. **Use only rechargeable battery(ies).**
- Do not mix old and new batteries.
- Do not dispose of the battery(ies) in a fire, as they may explode. Check with local waste management codes for special disposal instructions.
- Do not open or mutilate the battery(ies). Released electrolyte from the battery(ies) is corrosive and may cause burns or injury to the eyes or skin. The electrolyte may be toxic if swallowed.
- Exercise care when handling the battery(ies). Do not allow conductive materials such as rings, bracelets or keys to touch the battery(ies), otherwise a short circuit may cause the battery(ies) and/or the conductive material to overheat and cause burns.
- Charge the battery(ies) provided with or identified for use with this product only in accordance with the instructions and limitations specified in this manual.
- Only use a compatible base unit (or charger) to charge the battery(ies). Do not tamper with the base unit (or charger). Failure to follow these instructions may cause the battery(ies) to swell or explode.

Notice for product disposal, transfer, or return

- This product can store your private/confidential information. To protect your privacy/confidentiality, we recommend that you erase the information such as phonebook or caller list entries from the memory before you dispose, transfer or return the product.

Information on Disposal in other Countries outside the European Union



This symbol is only valid in the European Union. If you wish to discard this product, please contact your local authorities or dealer and ask for the correct method of disposal.

Controls

Base unit

www.DataSheet4U.com

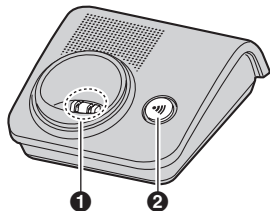

- 1 Charge contacts
- 2 [ⓘ] (Page)

Handset

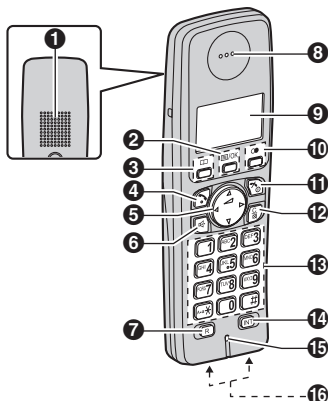

- 1 Speaker
- 2 [≡/OK] (Menu/OK)
- 3 [☎] (Phonebook)
- 4 [↶] (Talk)
- 5 Navigator key ([▲]/[▼]/[▶]/[←])/
⏪ (Receiver volume: [▲][▼])
- 6 [☎] (Speakerphone)
- 7 [R] (Flash)
- 8 Receiver
- 9 Display
- 10 [●] (Redial/Pause)

- 11 [⏻] (Off/Power)
- 12 [C/⊗] (Clear/Mute)
- 13 Dial keypad
- 14 [INT] (Intercom)
- 15 Microphone
- 16 Charge contacts

Using the navigator key

Press [▲], [▼], [←], or [▶] to navigate through menus and to select items shown on the display.



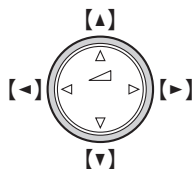

Adjusting the receiver or speaker volume (⏪)

Press [▲] or [▼] while on a call.



Displays

Display icons

Icon	Meaning
	Within range of a base unit <ul style="list-style-type: none"> When flashing: Handset is searching for base unit. (page 26)
	Handset is accessing base unit. (intercom, paging, changing base unit settings, etc.)
	Handset is on an outside call.
	Battery level
[P]	Call privacy mode is on. (page 15)
	New voice mail message received* ¹ (page 20)
[IN USE]	Line is being used by another handset for calling, registration, etc.

*1 Voice mail users only

Connections

Connect the telephone line cord until it clicks into the base unit and telephone line jack (1). Connect the AC adaptor cord (2) by pressing the plug firmly (3).

Base unit

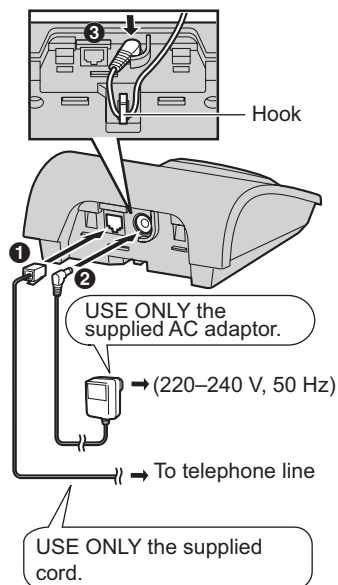

Important:

- If you use a telephone line cord which is not supplied, the unit may not work properly.

Charger (KX-TG7202)

www.DataSheet4U.com

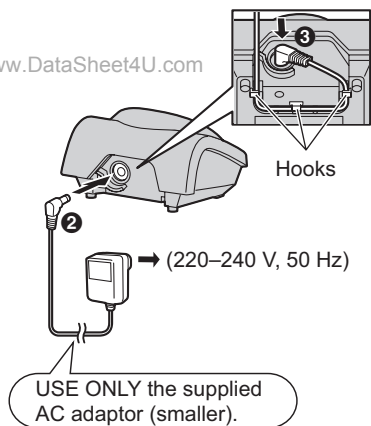
**Note:**

- Never install telephone wiring during a lightning storm.
- The AC adaptor must remain connected at all times. (It is normal for the adaptor to feel warm during use.)
- The AC adaptor should be connected to a vertically oriented or floor-mounted AC outlet. Do not connect the AC adaptor to a ceiling-mounted AC outlet, as the weight of the adaptor may cause it to become disconnected.
- The unit will not work during a power failure. We recommend connecting a corded telephone to the same telephone line or to the same telephone jack using a T-adaptor.

Location of base unit

- For maximum coverage and noise-free communications, place your base unit:
 - at a convenient, high, and central location with no obstructions between the handset and base unit in an indoor environment.

- away from electronic appliances such as TVs, radios, personal computers, wireless devices or other phones.
- avoid facing radiofrequency transmitters, such as external antennas of mobile phone cell stations (Avoid putting the base unit on the bay window or near the window).
- Coverage and voice quality depends on the local environmental conditions.
- If the reception for a base unit location is not satisfactory, move the base unit to another location for better reception.

Battery installation and replacement

Important:

- Use only the supplied rechargeable batteries noted on page 4, 6.
- USE ONLY rechargeable Ni-MH batteries AAA (R03) size.
- Do NOT use Alkaline/Manganese/Ni-Cd batteries.
- Ensure correct polarities (\oplus , \ominus) when installing the batteries.
- Wipe the battery ends (\oplus , \ominus) with a dry cloth.
- When installing the batteries, avoid touching the battery ends (\oplus , \ominus) or the unit contacts.
- When replacing batteries, we recommend using the Panasonic rechargeable batteries noted on page 4, 6.

www.DataSheet4U.com

Preparation

- 1 Press the notch on the handset cover firmly and slide it in the direction of the arrow.

www.DataSheet4U.com

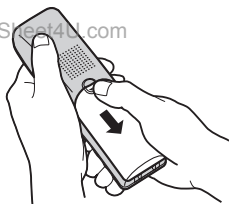

- 2 Insert the batteries negative (⊖) end first. Close the handset cover.

Rechargeable Ni-MH ONLY

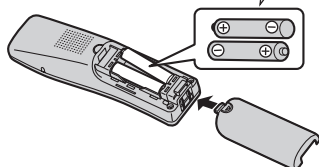

Note:

- When replacing batteries, remove the old batteries.

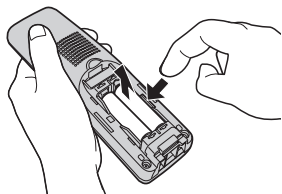

Battery charge

Place the handset on the base unit or charger for about 7 hours before initial use.

When charging, "Charging" will be displayed.

When the batteries are fully charged, "Charge Completed" will be displayed.

Base unit

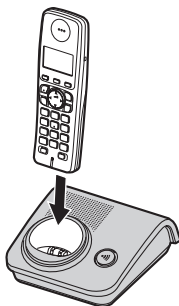

Charger*¹



*1 KX-TG7202

Note:

- It is normal for the handset to feel warm during charging.
- If you want to use the unit immediately, charge the batteries for at least 15 minutes.
- Clean the charge contacts of the handset, base unit, and charger with a soft, dry cloth once a month. Clean more often if the unit is subject to the exposure of grease, dust, or high humidity.

www.DataSheet4U.com

Battery level

Battery icon	Battery level
	High
	Medium
	Low <ul style="list-style-type: none"> When flashing: Needs to be charged.

Panasonic Ni-MH battery performance (supplied batteries)

Operation	Operating time
In continuous use	17 hours max.
In continuous standby mode	180 hours max.

Note:

- It is normal for batteries not to reach full capacity at the initial charge. Maximum battery performance is reached after a few complete cycles of charge/discharge (use).
- To maximize battery life, it is recommended that the handset batteries be fully discharged (used) until flashes once every few months.
- Actual battery performance depends on a combination of how often the handset is in use and how often it is not in use (standby).
- The battery level may not be displayed correctly after you replace the batteries. In this case, place the handset on the base unit or charger and let it charge for at least 7 hours.

Turning the power on/off**Power on**

Press **[*][0]** for about 1 second.

Power off

Press **[*][0]** for about 2 seconds.

Setting up the unit before use**Display language**

- [*][0]** → **[M]/OK**
- Press **[▲]** or **[▼]** to select “Handset Setup”. → **[▶]**
- Press **[▲]** or **[▼]** to select “Display Setup”. → **[▶]**
- Press **[▲]** or **[▼]** to select “Select Language”. → **[▶]**
- Press **[▲]** or **[▼]** to select the desired language. → **[▶]** → **[*][0]**

Note:

- If you select a language you cannot read: **[*][0]** → **[M]/OK** → **[▲]** 3 times → **[▶]** → **[▼]** 2 times → **[▶]** 2 times → **[▲]/[▼]**: Select the desired language. → **[▶]** → **[*][0]**

Dialling mode (tone/pulse)

Changing the dialling mode depending on your telephone line service.

"Tone": Select when you have a touch-tone service.

"Pulse": Select when you have rotary/pulse service.

- 1 [F5]/OK
- 2 Press [▲] or [▼] to select "Base Unit Setup". → [▶]
- 3 Press [▲] or [▼] to select "Call Options". → [▶]
- 4 Press [▲] or [▼] to select "Dial Mode". → [▶]
- 5 Press [▲] or [▼] to select the desired setting. → [▶] → [F6]

Date and time

- 1 [F5]/OK
- 2 Press [▲] or [▼] to select "Handset Setup". → [▶]
- 3 Press [▲] or [▼] to select "Set Date & Time". → [▶]
- 4 Enter the current date, month, and year.
Example: 17 May, 2007
[1][7] [0][5] [0][7]
- 5 Enter the current hour and minute.
Example: 3:30 PM
[0][3] [3][0] → Press [F6] until "03:30 PM" is displayed.
- 6 [F5]/OK → [F6]

Note:

- To correct a digit, press [◀] or [▶] to move the cursor, then make the correction.
- The date and time may be incorrect after a power failure. In this case, set the date and time again.

Making calls

- 1 Lift the handset and dial the phone number.
 - To correct a digit, press **[C/⌫]**.
- 2 **[↶]**
- 3 When finished talking, press **[⏏]** or place the handset on the base unit or charger.

Speakerphone

- 1 During a conversation, press **[☎]** to turn on the speakerphone.
 - Speak alternately with the caller.
- 2 When finished talking, press **[⏏]**.

Note:

- For best performance, use the speakerphone in a quiet environment.
- To switch back to the receiver, press **[↶]**.

Adjusting the receiver or speaker volume

Press **[▲]** or **[▼]** while on a call.

Making a call using the redial list

The last 10 phone numbers dialled are stored in the redial list (each 24 digits max.).

- 1 **[☎]**
- 2 **[▲]/[▼]**: Select the desired number.
- 3 **[↶]**

Erasing numbers in the redial list

- 1 **[☎]**
- 2 **[▲]/[▼]**: Select the desired number.
→ **[▶]**
- 3 **[▲]/[▼]**: "Erase" → **[▶]**

- 4 **[▲]/[▼]**: "Yes" → **[▶]** → **[⏏]**

Pause (for PBX/long distance service users)

A pause is sometimes required when making calls using a PBX or long distance service.

Example: If you have to dial **[0]** before dialling outside numbers manually, you will probably need to pause after dialling **[0]** until you hear a dial tone.

- 1 **[0]** → **[☎]**
- 2 Dial the phone number. → **[↶]**

Note:

- A 3 second pause is inserted each time **[☎]** is pressed. Repeat as needed to create longer pauses.

Answering calls

- 1 Lift the handset and press **[↶]** or **[☎]** when the unit rings.
 - You can also answer the call by pressing any dial key from **[0]** to **[9]**, **[*]**, or **#[#]**. (**Any key answer feature**)
- 2 When finished talking, press **[⏏]** or place the handset on the base unit or charger.

Auto talk feature

You can answer calls simply by lifting the handset off the base unit or charger. You do not need to press **[↶]**. To turn this feature on, see page 17.

Adjusting the handset ringer volume when receiving a call

Press **[▲]** or **[▼]**.

Handset locator

Using this feature, you can locate the handset if it has been misplaced.

- 1 Press **[📞]** on the base unit.
- 2 To stop paging, press **[📞]** on the base unit or press **[✖️]** on the handset.

Useful features during a call

Mute

While mute is turned on, you will be able to hear the other party, but the other party will not be able to hear you.

To mute your voice, press **[C/🔇]**.

- To return to the conversation, press **[C/🔇]** again.

R button

Pressing **[R]** allows you to use special features of your host PBX such as transferring an extension call, or accessing optional telephone services.

Note:

- To change the flash time, see page 18.

For Call Waiting service users

To use Call Waiting, you must subscribe to the Call Waiting service of your service provider/telephone company.

This feature allows you to receive calls while you are already talking on the phone. If you receive a call while on the phone, you will hear a Call Waiting tone.

Please contact your service provider/telephone company for details and availability of this service in your area. Press **[R]** to answer the 2nd call.

- To switch between calls, press **[R]**.

Temporary tone dialling (for rotary/pulse service users)

You can temporarily switch the dialling mode to tone when you need to access touch-tone services (e.g., telephone banking services).

- 1 Make a call.
- 2 Press **[*]** when prompted to enter your code or PIN, then press the appropriate dial keys.

Note:

- The dialling mode will return to pulse when you hang up.

Key lock

The handset can be locked so that no calls or settings can be made. Incoming calls can be answered, but all other functions are disabled while key lock is on.

To turn key lock on, press **[🔒/OK]** for about 3 seconds.

- “**Key Lock**” is displayed.
- To turn key lock off, press **[🔒/OK]** again for about 3 seconds.

Note:

- Calls to emergency numbers cannot be made until key lock is turned off.

Call share

A 2nd handset can join an existing outside call.

To join the conversation, press **[📞]** or **[📞]** when the other handset is on an outside call.

Call privacy

Call privacy allows you to prevent other users from joining your conversations with outside callers. To allow other users to join your conversations, leave this feature off. The default setting is “off”.

- 1 Press **[☰/OK]** during an outside call.
- 2 **[▲]/[▼]**: “on” or “off” → **[▶]**
 - When this feature is turned on, “[P]” is displayed.

Note:

- This feature will turn off after you hang up the call.

Handset phonebook

The handset phonebook allows you to make calls without having to dial manually. You can add 50 names and phone numbers.

Adding entries

- 1 [] → []/OK
- 2 [▲]/[▼]: "New Entry" → [▶]
- 3 Enter the party's name (16 characters max.; page 24). → []/OK
- 4 Enter the party's phone number (24 digits max.). → []/OK
- 5 [▲]/[▼]: "Save" → [▶] → []

Note:

- Step 1 variation:
[]/OK → [▲]/[▼]: Select "Ph. Book Setup". → [▶]

Finding and calling a handset phonebook entry

Scrolling through all entries

- 1 []
- 2 [▲]/[▼]: Select the desired entry.
- 3 []

Editing entries

- 1 Find the desired entry (page 16). → []/OK
- 2 [▲]/[▼]: "Edit" → [▶]
- 3 Edit the name if necessary (16 characters max.; page 24). → []/OK
- 4 Edit the phone number if necessary (24 digits max.). → []/OK

- 5 [▲]/[▼]: "Save" → [▶] → []

Erasing entries

Erasing an entry

- 1 Find the desired entry (page 16). → []/OK
- 2 [▲]/[▼]: "Erase" → [▶]
- 3 [▲]/[▼]: "Yes" → [▶] → []

Erasing all entries

- 1 [] → []/OK
- 2 [▲]/[▼]: "Erase All" → [▶]
- 3 [▲]/[▼]: "Yes" → [▶]
- 4 [▲]/[▼]: "Yes" → [▶] → []

Chain dial

This feature allows you to dial phone numbers in the handset phonebook while you are on a call. This feature can be used, for example, to dial a calling card access number or bank account PIN that you have stored in the handset phonebook, without having to dial manually.

- 1 While on a call, press [].
- 2 [▲]/[▼]: Select the desired entry.
- 3 Press [▶] to dial the number.

Note:

- If you are using this phone in pulse dialling mode, you may need to press [] to change the dialling mode to tone before chain dialling. When adding entries to the handset phonebook, we recommend adding [] to the beginning of phone numbers you wish to chain dial (page 16).

Handset settings

To customise the handset:

- 1 **[OK]**
- 2 Press **[▲]** or **[▼]** to select “**Handset Setup**”. → **[▶]**
- 3 Press **[▲]** or **[▼]** to select the desired item in the handset settings menu. → **[▶]**
- 4 Press **[▲]** or **[▼]** to select the desired item in the sub-menu. → **[▶]**
- 5 Press **[▲]** or **[▼]** to select the desired setting then press **[▶]**.
 - This step may vary depending on the feature being programmed.
 - To exit the operation, press **[*0]**.

Note:

- The current item or setting is indicated by **▶** on the display.

Menu	Sub-menu	Details (default setting)
Set Date & Time	—	page 12
Ringer Setup	Ringer Volume	For handset (<i>Maximum</i>) ^{*1}
	Ext. Ringtone	For outside calls (“Ringtone 1”) ^{*2, *3}
Display Setup	Select Language	(“English”): page 11
	Contrast	(<i>Level 3</i>)
Registration	Register H.set	page 21
Other Options	Keytones	(“On”)
	Auto Talk	(“Off”): page 13

*1 When the ringer volume is turned off, “**Ring Off**” is displayed and the handset does not ring for outside calls.

However even when the ringer volume is turned off, the handset rings:

- at the minimum level for intercom calls
- at the maximum level for paging

*2 If you select one of the melody ringtones, the ringtone will continue to sound for several seconds if the caller hangs up before you answer. You may hear a dial tone or no one on the line when you answer a call.

*3 The preset melodies in this product are used with permission of © 2006 Copyrights Vision Inc.

Base unit settings

To customise the base unit using the handset:

- 1 **[OK]**
- 2 Press **[▲]** or **[▼]** to select “**Base Unit Setup**”. → **[▶]**
- 3 Press **[▲]** or **[▼]** to select the desired item in the base unit settings menu. → **[▶]**
- 4 Press **[▲]** or **[▼]** to select the desired item in the sub-menu. → **[▶]**
- 5 Press **[▲]** or **[▼]** to select the desired setting then press **[▶]**.
 - This step may vary depending on the feature being programmed.
 - To exit the operation, press **[⏏]**.

Note:

- The current item or setting is indicated by **▶** on the display.

Menu	Sub-menu	Details (default setting)
Call Options	Dial Mode	(“Tone”): page 12
	Recall/Flash	Flash time (“400 msec.”) ^{*1}
Other Options	Base Unit PIN	Change base unit PIN (“0000”). ^{*2} – Enter the current 4-digit base unit PIN. ^{*3} – Enter the new 4-digit base unit PIN. → [▶] → [⏏]
	Repeater Mode	(“Off”): page 22

*1 Change the flash time, if necessary, depending on the requirements of your service provider/telephone company or PBX.

*2 If you change the PIN, please make note of your new PIN. The unit will not reveal the PIN to you.

*3 If you forget your PIN, consult your nearest Panasonic service centre.

Using Caller ID service

Important:

- This unit is Caller ID compatible. To use Caller ID features (such as displaying caller phone numbers), you must subscribe to Caller ID service. Consult your service provider/telephone company for details.

Caller ID features

When an outside call is received, the caller's phone number will be displayed.

- Phone numbers of the last 50 callers will be logged in the caller list.
- When caller information is received and it matches a phone number stored in the unit's phonebook, the stored name will be displayed and logged in the caller list.
- If the unit is connected to a PBX system, you may not receive the caller information.
- When the caller dialed from an area which does not provide Caller ID service, "Out of Area" will be displayed.
- When the caller requested not to send caller information, either no information or "Private Caller" will be displayed.

Missed calls

If a call is not answered, the unit treats the call as a missed call. The number of missed calls is shown on the display. This lets you know if you should view the caller list to see who called while you were out.

Call Waiting Caller ID display

If you subscribe to both Caller ID and Call Waiting with Caller ID services, the

2nd caller's information is displayed after you hear a Call Waiting tone. You can answer the 2nd call, keeping the 1st call on hold.

Note:

- Please contact your service provider/telephone company for details and availability of this service in your area.

Caller list

Viewing the caller list and calling back

- 1 **[☰/OK]**
- 2 **[▲]/[▼]: "Caller List" → [▶]**
- 3 Press **[▼]** to search from the most recent call, or press **[▲]** to search from the oldest call.
 - If the item has already been viewed or answered, "✓" is displayed, even if it was viewed or answered using another handset.
- 4 **[↶]**

Editing a caller's phone number before calling back

- 1 **[☰/OK]**
- 2 **[▲]/[▼]: "Caller List" → [▶]**
- 3 **[▲]/[▼]:** Select the desired entry. → **[☰/OK]**
- 4 **[▲]/[▼]: "Edit and Call" → [▶]**
- 5 Edit the number.
 - Press dial key (**[0]** to **[9]**) to add, **[C/✕]** to delete.
- 6 **[↶]**

Erasing caller information

- 1 [M]/OK
- 2 [▲]/[▼]: "Caller List" → [▶]
- 3 [▲]/[▼]: Select the desired entry.
→ [M]/OK
- 4 [▲]/[▼]: "Erase" or "Erase All"
→ [▶]
- 5 [▲]/[▼]: "Yes" → [▶] → [↶⊙]

Storing caller information into the handset phonebook

- 1 [M]/OK
- 2 [▲]/[▼]: "Caller List" → [▶]
- 3 [▲]/[▼]: Select the desired entry.
→ [M]/OK
- 4 [▲]/[▼]: "Add Phonebook" → [▶]
- 5 Continue from step 3, "Adding entries", page 16.

Voice mail service

Voice mail is an automatic answering service offered by your service provider/telephone company. If you subscribe to this service, your service provider/telephone company's voice mail system will answer calls for you when you are unavailable to answer the phone or when your line is busy. Messages are recorded by your service provider/telephone company, not your telephone. When you have new messages,  will be displayed on the handset. Please consult your service provider/telephone company for details of this service.

Note:

- If  still remains on the display even after you have listened to new

messages, turn it off by pressing and holding [C/⊗] for 2 seconds.

Operating additional units

www.DataSheet4U.com

Additional handsets

Up to 6 handsets can be registered to the base unit.

Important:

- The additional handset model recommended for use with this unit is noted on page 4. If other model handset is used, certain operations (handset settings, base unit settings, etc.) may not be available.
- Additional handsets will give you the freedom to, for example, have an intercom call with another handset while a third handset is on an outside call.

Registering a handset to the base unit

The supplied handset and base unit are pre-registered. When you purchase an additional handset, refer to the additional handset's installation manual for registration. If for some reason the handset is not registered to the base unit (for example, Υ flashes even when the handset is near the base unit), register the handset.

- 1 **[\square]/OK**
- 2 **[\blacktriangle]/[\blacktriangledown]: "Handset Setup" \rightarrow [\blacktriangleright]**
- 3 **[\blacktriangle]/[\blacktriangledown]: "Registration" \rightarrow [\blacktriangleright]**
- 4 **[\blacktriangle]/[\blacktriangledown]: "Register H.set" \rightarrow [\blacktriangleright]**

- 5 Press and hold **[\blacktriangleright]** on the base unit for about 5 seconds. (No registration tone)
 - If all registered handsets start ringing, press **[\blacktriangleright]** to stop, then repeat this step.
 - After pressing **[\blacktriangleright]**, the rest of this procedure must be completed within 90 seconds.
- 6 Wait until "Enter Base PIN" is displayed. \rightarrow Enter the base unit PIN (default: "0000"). \rightarrow **[\square]/OK**
 - If you forget your PIN, consult your nearest Panasonic service centre.
 - When the handset has been registered successfully, Υ will stop flashing. If the key tone is turned on (page 17), a confirmation tone will be heard.

Deregistering a handset

A handset can cancel its own registration (or the registration of another handset) that is stored in the base unit. This will allow the base unit to "forget" the handset.

- 1 **[\square]/OK**
- 2 **[\blacktriangle]/[\blacktriangledown]: "Base Unit Setup" \rightarrow [\blacktriangleright]**
- 3 Enter "335".
- 4 **[\blacktriangle]/[\blacktriangledown]: "Deregistration" \rightarrow [\blacktriangleright]**
 - The numbers of all handsets registered to the base unit are displayed.
- 5 Select the handset(s) you want to cancel, by pressing the desired handset number. \rightarrow **[\square]/OK**
 - The selected handset number(s) will flash.

- To cancel a selected handset number, press the number again. The number will stop flashing.

6 **[▲]/[▼]: “Yes” → [▶]**

- A long beep will sound as each handset number disappears.
- The handset does not beep when cancelling its own registration.

7 **[✕] [○]**

Increasing the range of the base unit

You can increase the signal range of the base unit by using a DECT repeater. Please use only the Panasonic DECT repeater noted on page 4. Consult your Panasonic dealer for details.

Important:

- Before registering the repeater to this base unit, you must turn the repeater mode on.
- Do not use more than one repeater at a time.

Setting the repeater mode

1 **[≡]/[OK]**

2 **[▲]/[▼]: “Base Unit Setup” → [▶]**

3 **[▲]/[▼]: “Other Options” → [▶]**

4 **[▲]/[▼]: “Repeater Mode” → [▶]**

5 **[▲]/[▼]: “On” or “Off” → [▶] → [✕] [○]**

Note:

- After turning repeater mode on or off, **Y** will flash on the handset momentarily. This is normal. The handset can be used once **Y** stops flashing.

Intercom between handsets

Intercom calls can be made between handsets.

Example: When handset 1 calls handset 2

1 **Handset 1:**

[INT] → Press **[2]** (desired handset number).

2 **Handset 2:**

[↶]

3 When finished talking, press

[✕] [○].

Transferring calls between handsets

Outside calls can be transferred between 2 people.

Example: When handset 1 transfers a call to handset 2

1 **Handset 1:**

During an outside call, press **[INT]**. → Press **[2]** (desired handset number).

- The outside call will be put on hold.

- If there is no answer, press **[INT]** to return to the outside call.

2 **Handset 2:**

Press **[↶]** to answer the page.

- Handset 2 can talk with handset 1.

3 **Handset 1:**



To complete the call transfer, press **[✕] [○]**.

Transferring a call without speaking to the other handset user

1 During an outside call, press **[INT]**.

www.DataSheet4U.com → Press the desired handset number.

-  flashes to indicate the outside call is on hold.

2 [ 

- The outside call rings at the other handset.

Note:

- If the other handset user does not answer the call within 1 minute, the call will ring at your handset again.

Character entry

The dial keys are used to enter characters and numbers. Each dial key has multiple characters assigned to it. The available character entry modes are Alphabet (ABC), Numeric (0-9), Greek (ΑΒΓ), Extended 1 (ΑΑΑ), Extended 2 (ΣΣΣ), and Cyrillic (АБВ). When in these entry modes except Numeric, you can select which character is entered by pressing a dial key repeatedly.

- Press [**←**] or [**→**] to move the cursor.
- Press dial keys to enter characters and numbers.
- Press [**C/✕**] to erase the character or number highlighted by the cursor. Press and hold [**C/✕**] to erase all characters or numbers.
- Press [*****] to switch between uppercase and lowercase.
- To enter another character located on the same dial key, press [**▶**] to move the cursor to the next space, then press the appropriate dial key.

Character entry modes

Several character entry modes can be used when entering text. The characters that can be entered depend on the entry mode.

Characters available in each character entry mode

When the unit displays the character entry screen:

[□] → [**▲**]/[**▼**]: Select a character entry mode. → [**▶**]

Alphabet character table (ABC)

0	1	ABC 2	DEF 3	GHI 4	JKL 5	MNO 6	PQRS 7	TUV 8	WXYZ 9
Space 0	Space # & ' () * 2	A B C 2	D E F 3	G H I 4	J K L 5	M N O 6	P Q R S 7	T U V 8	W X Y Z 9
	, - . / 1	a b c 2	d e f 3	g h i 4	j k l 5	m n o 6	p q r s 7	t u v 8	w x y z 9

Numeric entry table (0-9)

0	1	ABC 2	DEF 3	GHI 4	JKL 5	MNO 6	PQRS 7	TUV 8	WXYZ 9
0	1	2	3	4	5	6	7	8	9

Greek character table (ΑΒΓ)

0	1	ABC 2	DEF 3	GHI 4	JKL 5	MNO 6	PQRS 7	TUV 8	WXYZ 9
Space 0	Space # & ' () * 2	A B Γ 2	Δ E Z 3	H Θ I 4	K Λ M 5	N Ξ O 6	Π Ρ Σ 7	T Υ Φ 8	X Ψ Ω Ξ 9
	, - . / 1								

Extended 1 character table (AÄÅ)

0	1	ABC 2	DEF 3	GHI 4	JKL 5	MNO 6	PQRS 7	TUV 8	WXYZ 9
Space 0	Space # & ' () * , - . / 1	A Ä Å Å Ä Å À Á Â Ã Ä Å Ā ā Ă ă Ą ą Ć ć 2	D E Ę É Ê Ë Ĕ ĕ Ė ė Ę ę 3	G Ğ H I Ì Í Î Ĵ ĵ 4	J K L 5	M N Ń O Ő Ó Ô Õ Ö ø 6	P Q R S Ş 7	T U Ü Ú Û Ü Ū ū V 8	W Ŵ X Y ŷ Z 9
		a à á â ä å ā ā ą ą ć 2	d e è é ê ë ė ę ę 3	g ğ h i ì í î ĵ 4	j k l 5	m n ñ o ő ó ô õ ö ø 6	p q r s ş 7	t u ù ú û ü ū ū v 8	w ŵ x y ŷ z 9

- The following are used for both uppercase and lowercase: ø Ş Ŵ ŷ

Extended 2 character table (ŠŠš)

0	1	ABC 2	DEF 3	GHI 4	JKL 5	MNO 6	PQRS 7	TUV 8	WXYZ 9
Space 0	Space # & ' () * , - . / 1	A Ä Å Ā ā Ă ă Ą ą Ć ć 2	D Ď E É Ě ě Ě ě F 3	G H I Í 4	J K L Ł ł 5	M N Ń Ń Ń Ń Ŏ ŏ 6	P Q R Ŕ Ŕ Ŕ Ŕ Ŗ š š š 7	T Ť U Ú Û Ü Ū ū 8	W X Y ŷ Ý Ź Ž ž Ž 9
		a á ä ā ā ă ă ą ą ć 2	d ě e é ě ě ě ě f 3	g h i í 4	j k l ł ł 5	m n ń ń ń ń ň ő ó 6	p q r ŕ ŕ ŕ ŕ ř š š š 7	t ť u ú û ü ū ū 8	w x y ŷ ý ź ž ž ž 9

- The following are used for both uppercase and lowercase:

Ą Ć Ć Ę Ł Ł Ł Ń Ŕ Š Š ŷ Ź Ž Ž

Cyrillic character table (АБВ)

0	1	ABC 2	DEF 3	GHI 4	JKL 5	MNO 6	PQRS 7	TUV 8	WXYZ 9
Space 0 Г Є І Ї ҃	Space # & ' () * , - . / 1	А Б В Г 2	Д Е Ж З 3	И Й К Л 4	М Н О П 5	Р С Т У 6	Ф Х Ц Ч 7	Ш Щ Ъ Ь 8	Ь Э Ю Я 9

Error messages

Error message	Cause & solution
Memory Full	<ul style="list-style-type: none"> The handset's phonebook memory is full. Erase unnecessary entries (page 16).
No link to base. Move closer to base, try again.	<ul style="list-style-type: none"> The handset has lost communication with the base unit. Move closer to the base unit and try again. Unplug the base unit's AC adaptor to reset the unit. Reconnect the adaptor and try again. The handset's registration may have been cancelled. Re-register the handset (page 21).
You must first subscribe to Caller ID.	<ul style="list-style-type: none"> You must subscribe to Caller ID service. Once you receive caller information after subscribing to Caller ID service, this message will not be displayed.

Troubleshooting



If you still have difficulties after following the instructions in this section, disconnect the base unit AC adaptor and turn off the handset, then reconnect the base unit AC adaptor and turn on the handset.

Telephone

Problem	Cause & solution
Y is flashing.	<ul style="list-style-type: none"> The handset is not registered to the base unit. Register it (page 21). The handset is too far from the base unit. Move closer. The base unit AC adaptor is not connected. Check the connections. You are using the handset or base unit in an area with high electrical interference. Place the handset and base unit away from interference sources, such as antennas and mobile phones.
The handset display is blank.	<ul style="list-style-type: none"> The handset is not turned on. Turn the power on (page 11).
The handset will not turn on.	<ul style="list-style-type: none"> Make sure that the batteries are installed correctly (page 9). Fully charge the batteries (page 10). Clean the charge contacts and charge again (page 10).

Problem	Cause & solution
I have changed the display language to a language I cannot read.	<ul style="list-style-type: none"> ● Change the display language (page 11).
I cannot make or receive calls.	<ul style="list-style-type: none"> ● The base unit AC adaptor or telephone line cord is not connected. Check the connections. ● If you are using a splitter to connect the unit, remove the splitter and connect the unit to the wall socket directly. If the unit operates properly, check the splitter. ● Disconnect the base unit from the telephone line and connect the line to a known working telephone. If the working telephone operates properly, contact our service personnel to have the unit repaired. If the working telephone does not operate properly, contact your service provider/telephone company. ● The dialling mode setting is incorrect. Set to “Tone” or “Pulse” as needed (page 12). ● The key lock feature is turned on. Turn it off (page 14).
The unit does not ring.	<ul style="list-style-type: none"> ● The ringer volume is turned off. Adjust the ringer volume (page 17, 18).
The batteries should be charging but the battery icon does not change.	<ul style="list-style-type: none"> ● Clean the charge contacts and charge again (page 10).
A busy tone is heard when  is pressed.	<ul style="list-style-type: none"> ● The handset is too far from the base unit. Move closer and try again. ● Another handset is in use. Wait and try again later.
Static is heard, sound cuts in and out. Interference from other electrical units.	<ul style="list-style-type: none"> ● Place the handset and the base unit away from other electrical appliances. ● Move closer to the base unit. ● Your unit is connected to a telephone line with DSL service (page 28).
Noise is heard during a call.	<ul style="list-style-type: none"> ● You are using the handset or base unit in an area with high electrical interference. Place the handset and base unit away from interference sources, such as antennas and mobile phones.
The handset stops working while being used.	<ul style="list-style-type: none"> ● Disconnect the base unit AC adaptor and turn off the handset. Connect the base unit AC adaptor, turn on the handset and try again.

Useful Information

Problem	Cause & solution
The handset beeps intermittently and/or  flashes.	<ul style="list-style-type: none">Fully charge the batteries (page 10).
I fully charged the batteries, but  still flashes.	<ul style="list-style-type: none">Clean the charge contacts and charge again (page 10).It is time to replace the batteries (page 9).
I fully charged the batteries, but the operating time seems to be short.	<ul style="list-style-type: none">Wipe the battery ends (+, -) and the unit contacts with a dry cloth.
Caller information is not displayed.	<ul style="list-style-type: none">You need to subscribe to Caller ID service. Consult your service provider/telephone company for details.Your unit is connected to a telephone line with DSL service (page 28).
I cannot register a handset to the base unit.	<ul style="list-style-type: none">The maximum number of handsets (6) are already registered to the base unit. Cancel unused handset registrations from the base unit (page 21).You entered the wrong PIN. If you forget your PIN, consult your nearest Panasonic service centre.Place the handset and the base unit away from other electrical appliances.
I do not know how to erase the missed call number (for example, "3 Calls") from the display.	<ul style="list-style-type: none">There are unviewed missed calls remaining. View them using the following method.<ol style="list-style-type: none"> [OK][▲]/[▼]: "Caller List" → [▶]Press [▼] to search from the most recent call, or press [▲] to search from the oldest call.

For DSL users

We recommend connecting a filter (contact your DSL service provider) to the telephone line between the base unit and the telephone line jack.

Specifications

■ Standard:

DECT (Digital Enhanced Cordless Telecommunications),
GAP (Generic Access Profile)

■ Number of channels:

120 Duplex Channels

■ Frequency range:

1.88 GHz to 1.90 GHz

■ Duplex procedure:

TDMA (Time Division Multiple Access)

■ Channel spacing:

1,728 kHz

■ Bit rate:

1,152 kbit/s

■ Modulation:

GFSK (Gaussian Frequency Shift Keying)

■ RF transmission power:

Approx. 250 mW

■ Voice coding:

ADPCM 32 kbit/s

■ Power source:

220–240 V, 50 Hz

■ Power consumption

Base unit:

Standby: Approx. 2.1 W
Maximum: Approx. 6.0 W

Charger*1:

Standby: Approx. 1.0 W
Maximum: Approx. 5.4 W

■ Operating conditions:

5 °C–40 °C, 20 %–80 % relative air humidity (dry)

■ Dimensions:

Base unit: Approx. 54 mm × 122 mm × 137 mm

Handset: Approx. 155 mm × 48 mm × 32 mm

Charger*1: Approx. 53 mm × 81 mm × 91 mm

■ Mass (weight):

Base unit: Approx. 190 g

Handset: Approx. 130 g

Charger*1: Approx. 60 g

*1 KX-TG7202

Note:

- Specifications are subject to change.
- The illustrations used in these operating instructions may differ slightly from the actual product.

Index

- A** Additional handsets: 21
- Answering calls: 13
- Auto talk: 13, 17
- B** Base unit
 - Settings: 18
 - Battery: 9, 11
- C** Caller ID service: 19
- Call privacy: 15
- Call share: 14
- Call waiting: 14
- Chain dial: 16
- Character entry: 24
- D** Date and time: 12
- Dialling mode: 12
- Display
 - Contrast: 17
 - Icons: 8
 - Language: 11
- F** Flash: 14, 18
- H** Handset
 - Deregistration: 21
 - Locator: 14
 - Registration: 21
 - Settings: 17
- I** Intercom: 22
- K** Key lock: 14
- Keytones: 17
- M** Making calls: 13
- Missed calls: 19
- Mute: 14
- P** Pause: 13
- Phonebook
 - Handset phonebook: 16
 - PIN: 18
 - Power on/off: 11
- R** Redialling: 13
- Registration: 21
- Repeater: 22
- Ringtone: 17
- S** Speakerphone: 13
- T** Temporary tone dialling: 14

Transfer calls: 22

V Voice mail: 20

Volume

Receiver: 13

Ringer (Base unit): 18

Ringer (Handset): 17

Speaker: 13

Notes

www.DataSheet4U.com

Hotline Tel. No.: 2313 0666

**Sole Agent for Hong Kong & Macau:
Shun Hing Technology Co., Ltd.**

Block B, 9/F., Peninsula Centre 67 Mody Road Tsimshatsui East Kowloon,
Hong Kong

Tel: 2313 0888

Hotline: 2313 0666

Fax: 2368 8068

Email address: shtec@panasonic.oa.hk

Panasonic Communications Co., Ltd.

1-62, 4-chome, Minoshima, Hakata-ku, Fukuoka 812-8531, Japan

Copyright:

This material is copyrighted by Panasonic Communications Co., Ltd., and may be reproduced for internal use only. All other reproduction, in whole or in part, is prohibited without the written consent of Panasonic Communications Co., Ltd.

© 2007 Panasonic Communications Co., Ltd. All Rights Reserved.



TG7200HK

www.DataSheet4U.com