

TOLERANCE UNLESS SPECIFIED =

.XXX= +/- .005

.XX= +/- .015

FRACTIONS= +/- .032

PRODUCTION TESTS

URNS RATIO = 100%

DC RESISTANCE IN OHMS	1-3 =	723 NOM
	4-6 =	902 NOM
	7-9 =	2.6 NOM
	10-12 =	3.3 NOM

MAX EXCITATION CURRENT = 0.008 A

APPLY 230V 60HZ 1-6 (3+4)

PRI WDGS 114.5 TO 115.5 V

SEC WDGS 6.3 TO 7 V

HIPOT:	4000V P-S
	4000V P,S, TO CORE
	600 V P-P, S-S

CONTINUITY = 100% PRI'S IN FINAL
 IMPREGNATION: 2 HRS PREHEAT
 PINS TO BE FREE OF IMPREGNATION

FINAL ASSEMBLY NOTES

10-250.DC2

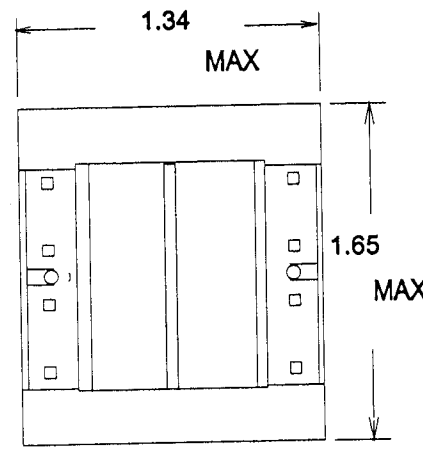
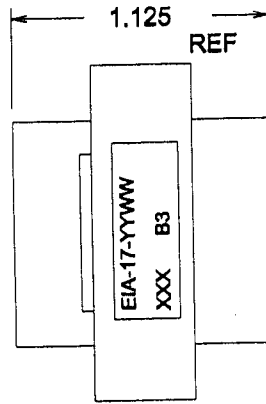
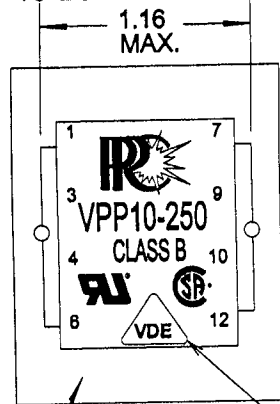

MTG.
1.06

ALL MANUFACTURING
SITES USE THIS MARK

NO VARNISH DRIPS
ON TOP SURFACE
OF LAMINATION.

PC PINS .025 SQ

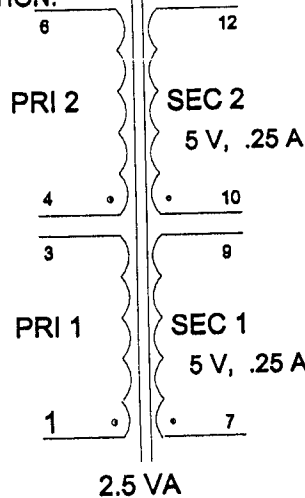
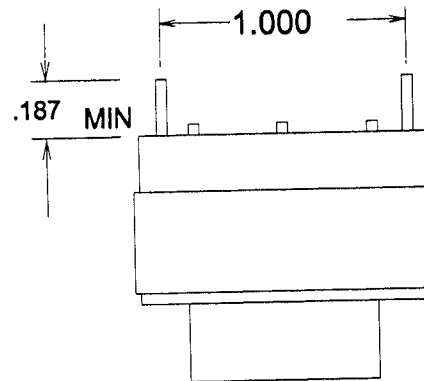

METHOD 1 X 1
LEAVE OFF LAST "I" PCS

MARKING ON SEE LABEL DETAIL ABOVE
APPLY PART NO. LABEL AFTER IMPREGNATION



PART NO.: VPP10-250