

Heatsinks

| Standard lengths | n | b / d Ø mm | $R_{thcw} (H_2O)$ | | w kg |
|---|---|---------------|--|---|---------|
| | | | $R_{th(case - cooling\ water)}$ K/W | $R_{th(thermal\ trip - cooling\ water)}$ K/W | |
| WK 31 + WK 32 $V_{W/t}: 2\ l/min$ $\Delta p: 45\ mbar$ | | | 0,150 | 0,015 | 1,44 |
| | | | 0,106 | 0,015 | |
| | | | 0,096 | 0,015 | |
| WK 31 + WK 32 $V_{W/t}: 4\ l/min$ $\Delta p: 180\ mbar$ | | | 0,128 | 0,012 | 1,44 |
| | | | 0,084 | 0,012 | |
| | | | 0,066 | 0,012 | |

Liquid cooling for capsule devices

WK 32

Publish Data

Features

- Intended for capsule devices
- Designed for water/liquid cooling

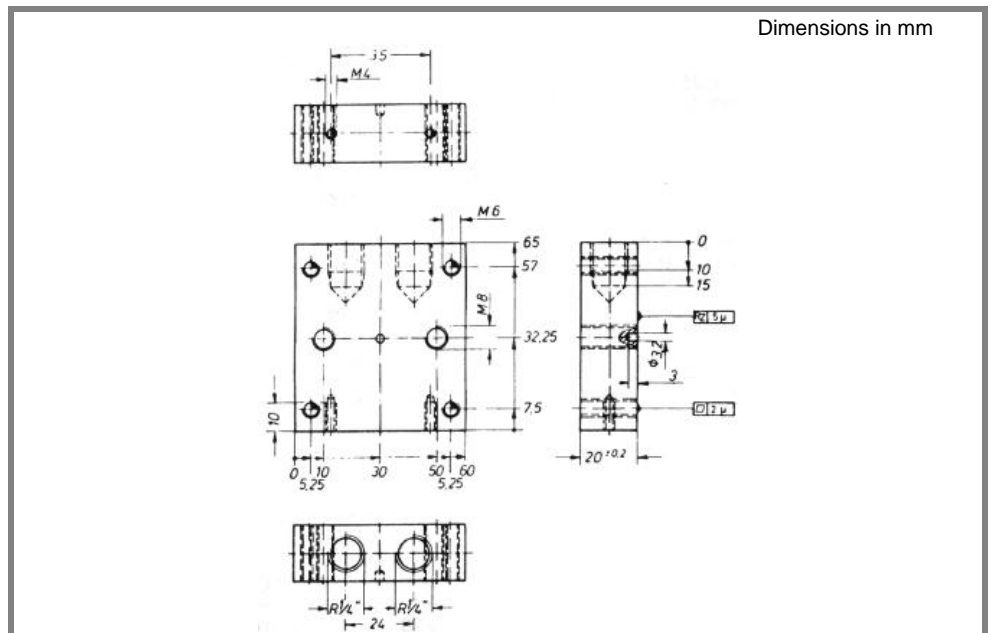

WK 32 (w = 0,61 kg) general profile dimensions

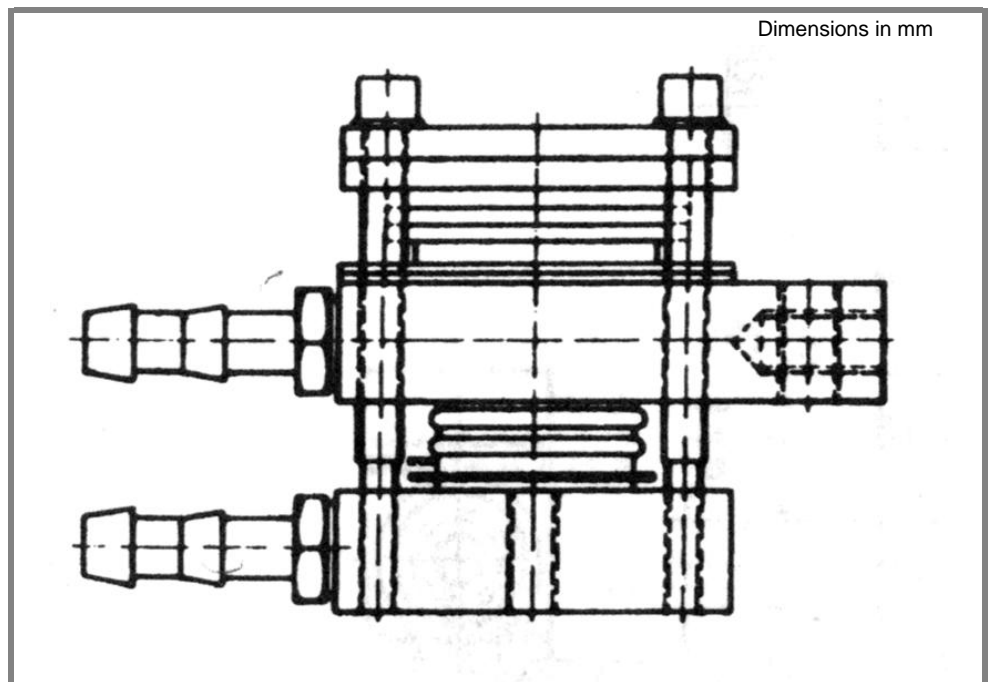

Example setup using heatsinks WK 31 + WK 32 for cooling of capsules

