



Sichuan Institute of Piezoelectric and Acousto-optic Technology

For PHS First IF Filters (SC04-01 Package)

SP 233

Electrical Characteristic:

Characteristic	Unit	Minimum	Typical	Maximum
Center Frequency	MHz	233.10	233.15	233.20
3dB Bandwidth	MHz	0.47	0.52	
Insertion Loss(at minimum loss point)	dB		14.2	15
Stop Band Attenuation (from peak level) at $F_0 \pm 0.6\text{MHz}$	dB	18		
Group Delay Deviation(with $F_0 \pm 150\text{kHz}$)	ns		200	300
Input/Output Impedance	Ω	50		
Package		SC04-01		
Ambient Temperature	$^{\circ}\text{C}$	25		

Input/Output Impedance(fig1):

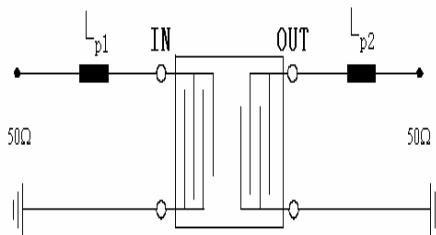

$$L_{p1}=27\text{nH}, \quad L_{p2}=39\text{nH}$$

This may be changed according to PCB.

SC04-01 Package(fig2):

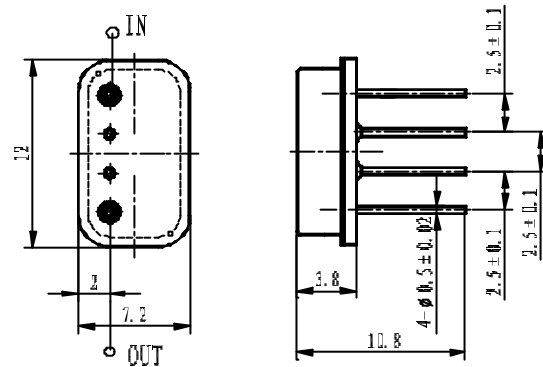

Frequency Characteristic(fig3):

