

**Ovel Type LED lamp**
**BL-L563**
**Features:**

- 5mm Ovel Type (5.0\*4.1\*7.1mm) LED Lamps
- Ultra brightness.
- Choice of various viewing angles.
- Diffused, Transparent and Water clear lens
- IC compatible /Low current capability.
- RoHs Compliance

**Electrical-optical characteristics: (Ta=25°C) (Test Condition: IF=20mA)**

Part Number	Chip			Lens Type	Forward Voltage(VF) Unit:V		Luminous Intensity (Iv) Unit:mcd		Viewing Angle 2θ1/2 (deg)
	Emitted Color	Material	λ <sub>p</sub> (nm)		Typ	Max	Min.	Typ.	
					BL-L563URC	Ultra Red	AlGaAs,DDH	660	
BL-L563UEC	Ultra Orange	AlGaInP	630	2.10	2.50	400	1250		
BL-L563UYC	Ultra Yellow	AlGaInP	590	2.10	2.50	350	1050		
BL-L563UGC	Ultra Green	AlGaInP	574	2.20	2.50	100	480		
BL-L563PGC	Ultra Pure Green	InGaN	525	3.80	4.50	900	2000		
BL-L563BGC	Ultra Bluish Green	InGaN	505	3.80	4.50	650	1700		
BL-L563BC	Blue	InGaN	430	3.80	4.50	350	1000		
BL-L563UBC	Ultra Blue	InGaN	470	2.70	4.20	800	1800		
BL-L563VC	UV	InGaN	405	3.80	4.50	60	100		
BL-L563UWC	Ultra White	InGaN	/	2.70	4.20	1200	2500		

**Absolute maximum ratings (Ta=25°C)**

Parameter	SR	LR	UR	UE	UY	UG	PG	BG	B	UB	UV	W	Unit
Forward Current I <sub>F</sub>	25	25	25	30	30	30	30	30	30	30	30	30	mA
Power Dissipation P <sub>d</sub>	60	60	60	65	65	75	110	110	120	120	120	120	mW
Reverse Voltage V <sub>R</sub>	5	5	5	5	5	5	5	5	5	5	5	5	V
Peak Forward Current I <sub>PF</sub> (Duty 1/10 @1KHZ)	150	150	150	150	150	150	150	100	100	100	100	100	mA
Operation Temperature T <sub>OPR</sub>	-40 to +80												
Storage Temperature T <sub>STG</sub>	-40 to +85												
Lead Soldering Temperature T <sub>SOI</sub>	Max.260 ± 5 for 3 sec Max. (1.6mm from the base of the epoxy bulb)												

Ovel Type LED lamp

BL-L563

Package configuration & Internal circuit diagram

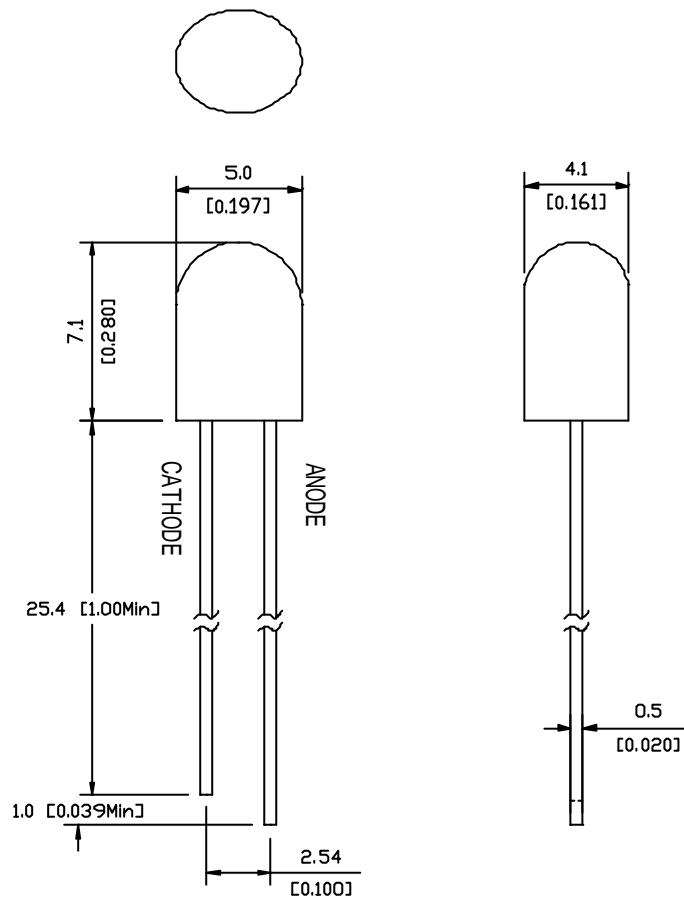

Notes:

1. All dimensions are in millimeters (inches)
2. Tolerance is  $\pm 0.25(0.01)$  unless otherwise noted.
3. Specifications are subject to change without notice.

## Ovel Type LED lamp

BL-L563

### Typical electrical-optical characteristics curves:

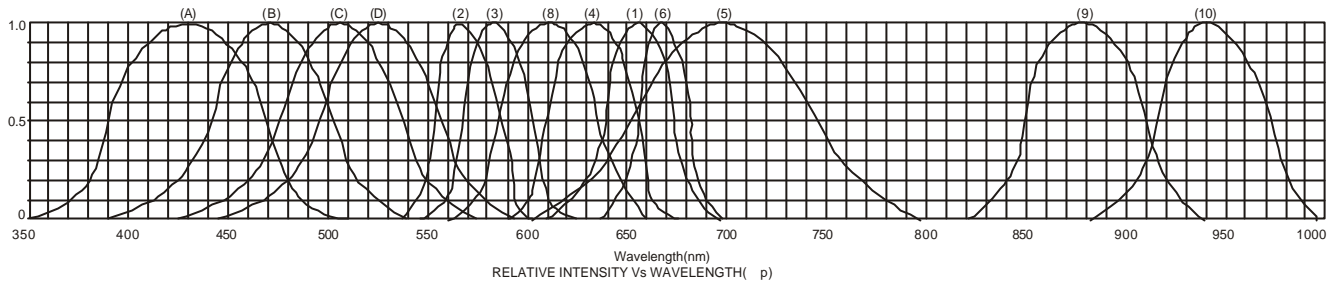

- (1) - GaAsP/GaAs 655nm/Red
- (2) - GaP 570nm/Yellow Green
- (3) - GaAsP/GaP 585nm/Yellow
- (4) - GaAsP/GaP 635nm/Orange & Hi-Eff Red
- (5) - GaP 700nm/Bright Red
- (6) - GaAlAs/GaAs 660nm/Super Red
- (8) - GaAsP/GaP 610nm/Super Red
- (9) - GaAlAs 880nm
- (10) - GaAs/GaAs & GaAlAs/GaAs 940nm
- (A) - GaN/SiC 430nm/Blue
- (B) - InGaN/SiC 470nm/Blue
- (C) - InGaN/SiC 505nm/Ultra Green
- (D) - InGaAl/SiC 525nm/Ultra Green

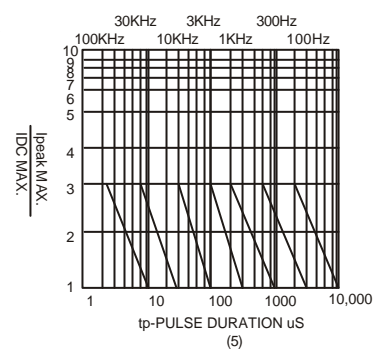
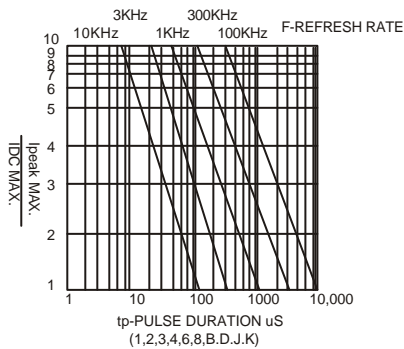
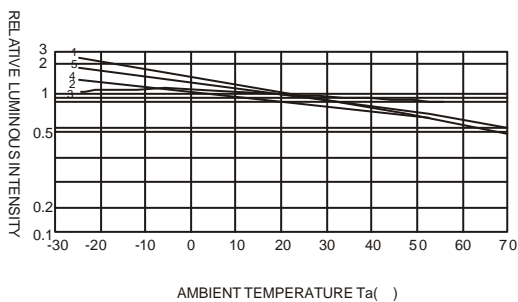
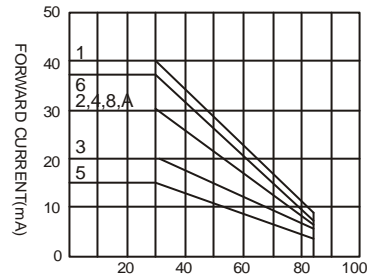
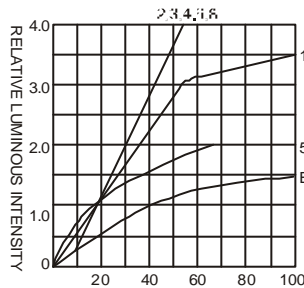

NOTE:25 free air temperature unless otherwise specified