

**PLEASE CHECK WWW.MOLEX.COM FOR LATEST PART INFORMATION**

**Part Number:** [0313811000](#)  
**Status:** **Active**  
**Description:** 38 Circuit ABS Way Receptacle, 2.8 Power Only

**Documents:**

[Packaging Specification \(PDF\)](#)      [Product Specification PS-31380-100 \(PDF\)](#)  
[Drawing \(PDF\)](#)      [RoHS Certificate of Compliance \(PDF\)](#)

**General**

Product Family      Crimp Housings  
Series      [31381](#)  
Product Name      N/A

**Physical**

Circuits (maximum)      38  
Color - Resin      Black  
Gender      Female  
Glow-Wire Compliant      No  
Keying to Mating Part      Yes  
Lock to Mating Part      Yes  
Material - Resin      Modified Polystyrene, Polyester, Polyphenylene Ether Alloy  
Number of Rows      3  
Packaging Type      Bag  
Panel Mount      No  
Pitch - Mating Interface (in)      0.157 In, 0.268 In, 0.311 In  
Pitch - Mating Interface (mm)      4.00 mm, 6.80 mm, 7.90 mm  
Pitch - Term. Interface (in)      0.157 In, 0.268 In, 0.311 In  
Pitch - Term. Interface (mm)      4.00 mm, 6.80 mm, 7.90 mm  
Polarized to Mating Part      Yes  
Ports      38  
Stackable      No  
Temperature Range - Operating      125°C

**Material Info**

**Reference - Drawing Numbers**

Product Specification      PS-31380-100  
Sales Drawing      SD-31381-100

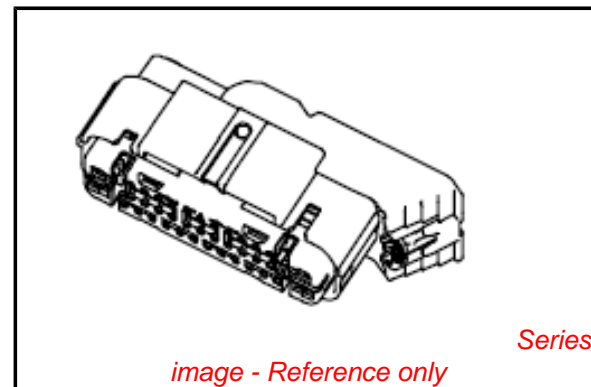

**EU RoHS**

**ELV and RoHS  
Compliant**  
**REACH SVHC**  
Not Reviewed  
**Halogen-Free  
Status**  
**Not Reviewed**

**China RoHS**



**Need more information on product  
environmental compliance?**

Email [productcompliance@molex.com](mailto:productcompliance@molex.com)  
For a multiple part number RoHS Certificate of Compliance, [click here](#)

Please visit the [Contact Us](#) section for any non-product compliance questions.

**Search Parts in this Series**

[31381Series](#)

**Mates With**

[313821001](#)

NOTES:

1. CONNECTOR TO BE SHIPPED WITH TPA IN PRE-LOAD POSITION AS SHOWN IN SECTION A-A.

2. ALL TEXT TO BE CLEARLY LEGIBLE AND 150MM MIN. HEIGHT. MARKING ORIENTATION MAY BE PARALLEL TO THE LENGTH OF THE PART, AS SHOWN, OR PERPENDICULAR TO THE LENGTH OF THE PART.

DATE CODE DESCRIPTION:

-1st THROUGH 3rd DIGIT = "DAY#" OF THE CALENDAR YEAR. (EXAMPLE FEB. 3rd = '034')

-LAST DIGIT = LAST DIGIT OF CALENDAR YEAR. (EXAMPLE: 2000 = '0')

SERIAL NUMBER DESCRIPTION:

-FIRST CHARACTER "M\_"= ASSEMBLY MACHINE NUMBER

-FOLLOWING NUMBER STARTS AT '00001' AND IS RESET FOR EACH NEW 'DAY#'. MOLEX PART NUMBER:

- SEE TABLE

3. DIMENSIONS NOT SHOWN CAN BE OBTAINED FROM THE ASSOCIATED MODEL.

4. FOR USE WITH THE FOLLOWING TERMINALS:

DELPHI GT280 P/N: 15304720

(MUST BE LUBRICATED WITH NYOGLER 760G LUBRICANT)

YAZAKI KAIZEN (CABLE SEALED) P/N: 7116-3703-02 (20 AWG GXL AND TXL)

7116-3704-02 (18 AWG TXL)

CONTACT TERMINAL MFR. FOR CRIMP AND CABLE SEAL SPECIFICATIONS.

5. MUST BE USED WITH WIRE SHIELD - MOLEX PART NUMBER 31382-1001. WIRE SHIELD SHIPPED SEPARATELY.

6. CONNECTOR SYSTEM MEETS ALL APPLICABLE REQUIREMENTS OF USCAR-2, REV. 4 EXCEPT:

SECTION 5.4.3 - LEVER ASSISTED MATE FORCE, PRE-LOCK RETENTION, THE FORCE REQUIRED TO UNSEAT THE CONNECTOR FROM ITS PRE-LOCK POSITION IS <= 75N.

SECTION 5.4.5 - TPA ENGAGE FORCE, PRE-LOCK TO FINAL LOCK, THE FORCE TO ENGAGE THE TPA FROM THE PRE-LOCK TO FINAL LOCK IS <= 75N.

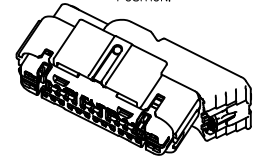
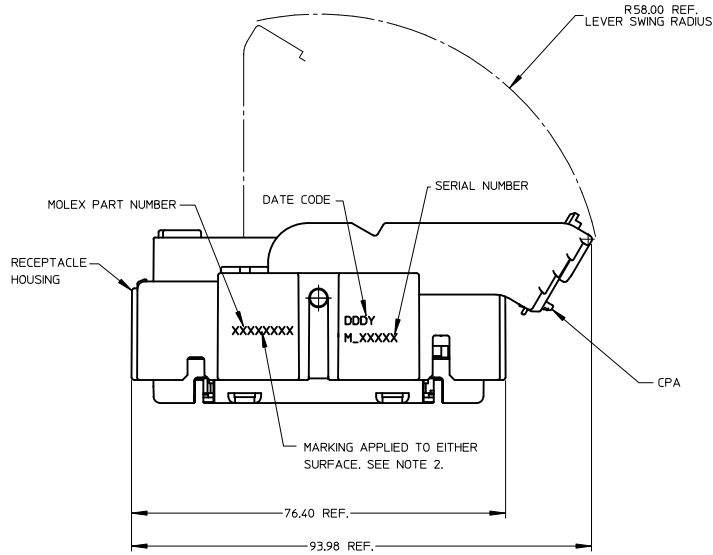

PART SHOWN WITH WIRE SHIELD INSTALLED. SHIELD SOLD SEPARATELY.

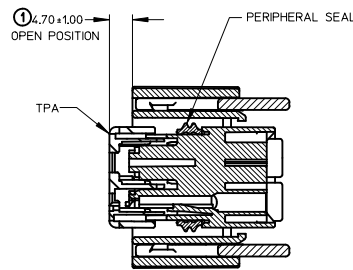
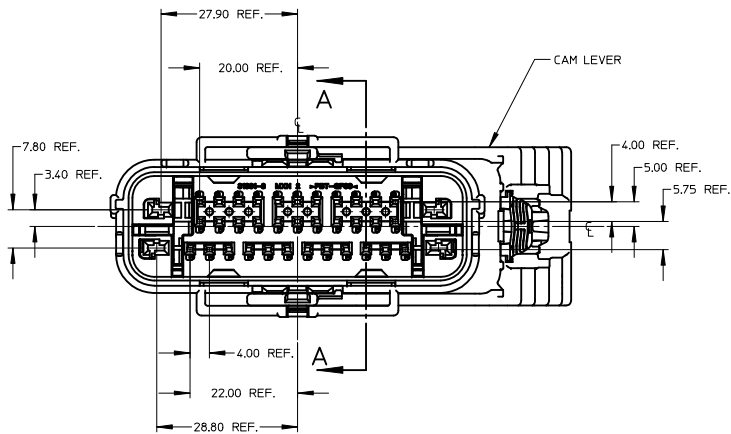
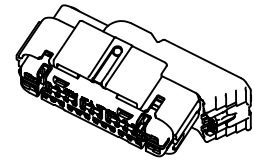

SECTION A-A

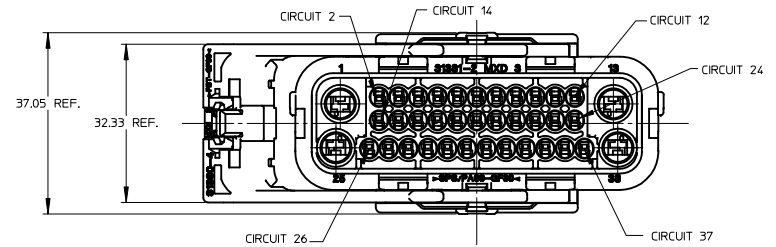

EC NO: UAL/2010-1518 DRAWN: MDANIELS 2010/03/08 CHKD: MDANIELS 04/15/2004 APPR: GPRATT 2010/03/08 E10	QUALITY SYMBOLS -0 -0	GENERAL TOLERANCES (UNLESS SPECIFIED)		SCALE 2:1	DESIGN UNITS METRIC	THIRD ANGLE PROJECTION	REVISE ON CAD ONLY
		DIMENSION STYLE MM ONLY	DIMENSION STYLE MM ONLY		TITLE 38 WAY ABS RECEPTACLE ASSY W/ 2.8 POWER ONLY CCW LVR THROW, SALES DWG		
		4 PLACES ± --- ± --- 3 PLACES ± --- ± --- 2 PLACES ± 0.13 ± --- 1 PLACE ± 0.25 ± ---	DRAWN BY MHASAN	DATE 04/08/2004	MOLEX MOLEX INCORPORATED		
		ANGULAR ± 1 ° DRAFT WHERE APPLICABLE MUST REMAIN WITHIN DIMENSIONS	CHECKED BY MDANIELS	DATE 04/15/2004	MATERIAL NO. 313811000	DOCUMENT NO. SD-31381-100	SHEET NO. 1 OF 2

### CIRCUIT OPTIONS

CUSTOMER PART NUMBER	CUST. CODE	MOLEX ASSEMBLY PART NUMBER	CAVITY NUMBER																																					
			2	3	4	5	6	7	8	9	10	11	12	13	14	15	16	17	18	19	20	21	22	23	24	26	27	28	29	30	31	32	33	34	35	36	37			
TBD	G	31381-1000																																						
TBD	G	31381-1001	X	X	X	X	X	X	X	X	X	X	X	X	X	X	X	X	X	X	X	X	X	X	X	X	X	X	X	X	X	X	X	X	X	X	X	X	X	
TBD	G	31381-1002	X	X	X	X	X	X	X	X	X	X	X	X	X	X	X	X	X	X	X	X	X	X	X	X	X	X	X	X	X	X	X	X	X	X	X	X	X	
TBD	G	31381-1003				X		X	X	X	X	X	X									X	X														X	X		
TBD	G	31381-1005			X			X	X	X								X				X	X						X	X							X			
TBD	G	31381-1006			X	X		X	X	X							X					X	X					X	X	X							X			
TBD	G	31381-1009					X										X					X	X														X			
TBD	G	31381-1010	X	X	X		X			X	X	X	X				X	X			X					X			X	X	X	X	X	X						
TBD	G	31381-1011				X			X								X	X			X																			
TBD	G	31381-1012	X	X	X			X	X	X	X	X					X	X				X	X					X	X							X	X			
TBD	G	31381-1013	X	X	X			X	X	X	X	X					X	X				X					X										X	X		
TBD	G	31381-1014	X	X	X			X	X	X	X	X	X						X							X	X	X	X	X	X	X	X	X	X	X	X	X	X	
TBD	G	31381-1015		X	X			X	X	X							X					X	X					X	X								X			
TBD	G	31381-1016		X	X			X	X	X							X					X	X					X	X											
TBD	G	31381-1017				X		X		X							X	X				X						X	X	X	X	X								
TBD	G	31381-1018		X		X		X		X							X	X				X	X					X	X									X		
TBD	G	31381-1020	X		X			X		X	X	X	X	X	X			X	X			X	X			X	X	X	X	X	X	X	X	X	X	X	X	X	X	

BILL OF MATERIAL						
MOLEX ASSY. PART NO.	HOUSING	TPA	CAM LEVER	CPA	PERIPHERAL SEAL	
31381-1000	31381-2000					
31381-1001	31381-2001					
31381-1002	31381-2002					
31381-1003	31381-2003					
31381-1005	31381-2005					
31381-1006	31381-2006					
31381-1009	31381-2009					
31381-1010	31381-2010					
31381-1011	31381-2011	31381-3000	31380-4000	34585-0002	31193-2000	
31381-1012	31381-2012					
31381-1013	31381-2013					
31381-1014	31381-2014					
31381-1015	31381-2015					
31381-1016	31381-2016					
31381-1017	31381-2017					
31381-1018	31381-2018					
31381-1020	31381-2020					

### PART VIEWS WITH WIRE SHIELD INSTALLED

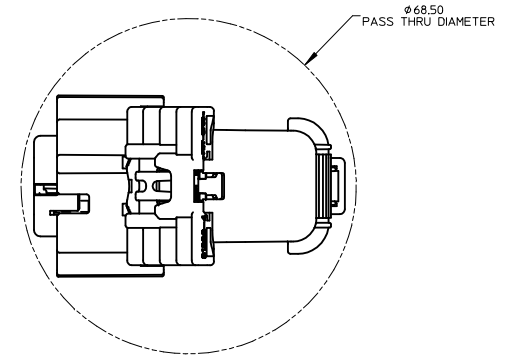
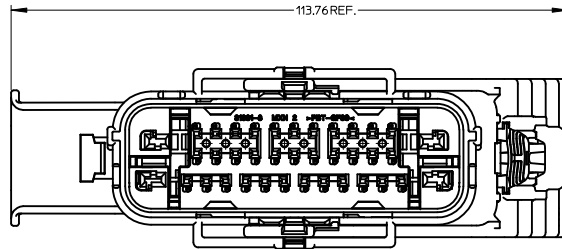

EC NO: UAU2010-1518 DRAWN: MDANIELS 2010/03/08 CHECKED: MDANIELS 04/15/2004 APPR: GPRATT - 2010/03/08 E10	QUALITY SYMBOLS 0 0	GENERAL TOLERANCES (UNLESS SPECIFIED) .mm INCH		SCALE: 2:1	DESIGN UNITS: METRIC	THIRD ANGLE PROJECTION REVISE ON CAD ONLY	
		4 PLACES ± .05	± .001	DIMENSION STYLE: MM ONLY	DRAWN BY: MHASAN DATE: 04/08/2004		
		3 PLACES ± .05	± .001	2 PLACES ± 0.13	± .001	CHECKED BY: MDANIELS DATE: 04/15/2004	TITLE: 38 WAY ABS RECEPTACLE ASSY W/ 2.8 POWER ONLY CCW LVR THROW, SALES DWG MOLEX MOLEX INCORPORATED MATERIAL NO. 313811000 DOCUMENT NO. SD-31381-100 SHEET NO. 2 OF 2
		1 PLACE ± 0.25	± .001	ANGULAR ± 1°	APPROVED BY: GPRATT DATE: 2010/03/08		
DRAFT WHERE APPLICABLE MUST REMAIN WITHIN DIMENSIONS		THIS DRAWING CONTAINS INFORMATION THAT IS PROPRIETARY TO MOLEX INCORPORATED AND SHOULD NOT BE USED WITHOUT WRITTEN PERMISSION					