



Data Sheet



Product Category: RF SAW Filter

Part Number
802-RF1575.42M-A

Package
3.0 x 3.0 SMD

Application
GPS

Last Modified
Apr. 12 2003

TYPE :
1575.42 MHz RF SAW Filter

PART NUMBER :
802-RF1575.42M-A



OPERATING CONDITIONS / ELECTRICAL CHARACTERISTICS

PARAMETERS	Condition	Minimum	Typical	Maximum	Units
Center Frequency	-	-	1575.42	-	MHz
Insertion Loss	1574.22 ~ 1576.62 MHz	-	1.85	2.0	dB
DC Voltage	-	-	-	0	V
Input Power	-	-	-	10	dBm
Operating Temperature	-	-40	-	+85	°C
Storage Temperature	-	-40	-	+85	°C
Amplitude Ripple	1574.22 ~ 1576.62 MHz	-	0.15	1.0	dB
Stopband Attenuation	DC ~ 1450.0MHz	35.0	39.0	-	dB
	1450.0 ~ 1500.0 MHz	30.0	38.0	-	
	1625.0 ~ 1640.0 MHz	40.0	48.0	-	
	1640.0 ~ 2000.0 MHz	30.0	37.0	-	
	2000.0 ~ 3000.0 MHz	30.0	30.9	-	
VSWR	1574.22 ~ 1576.62 MHz	-	1.3	2.0	-
Terminating Impedance	-	-	50	-	ohm

* Maximum Rating (Ta=25°C)
** Custom SAW RF Filters available. Contact Oscilent for assistance.

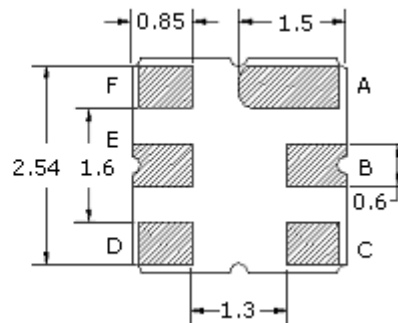
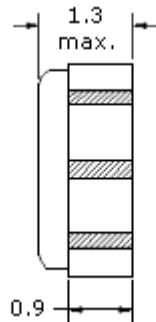
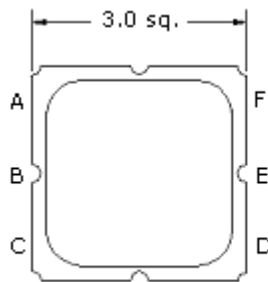

A	Ground
B	Output
C	Ground
D	Ground
E	Input
F	Ground

Frequency Reponse

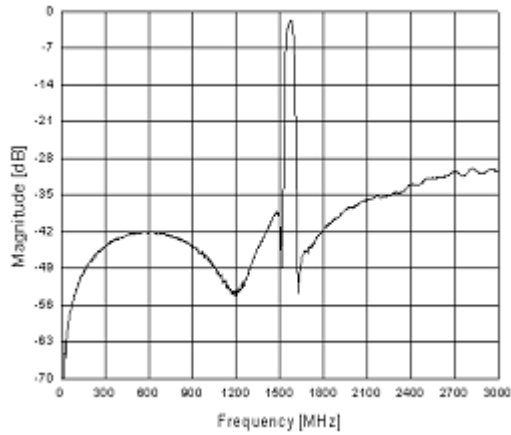
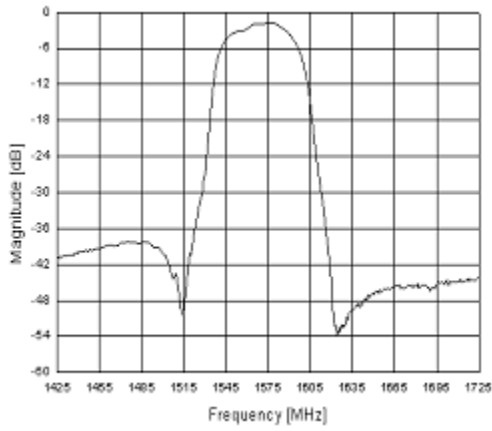

VSWR (S11, S22)

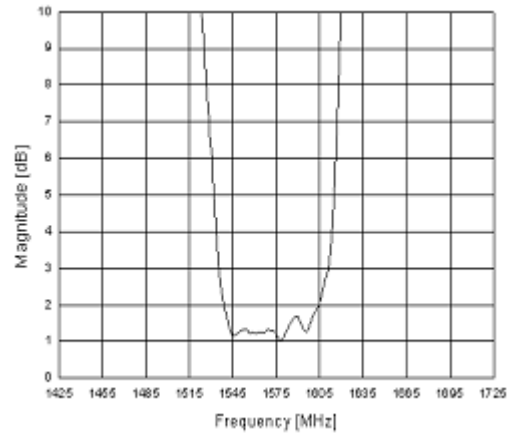
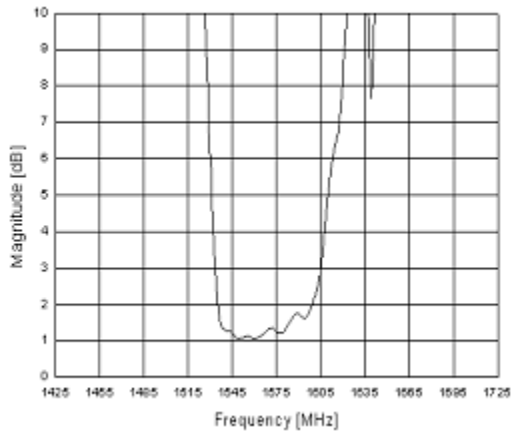

Smith Chart

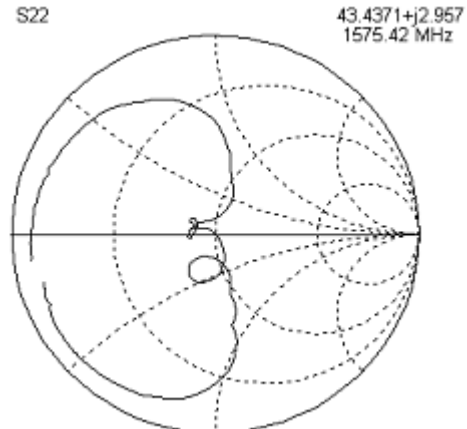
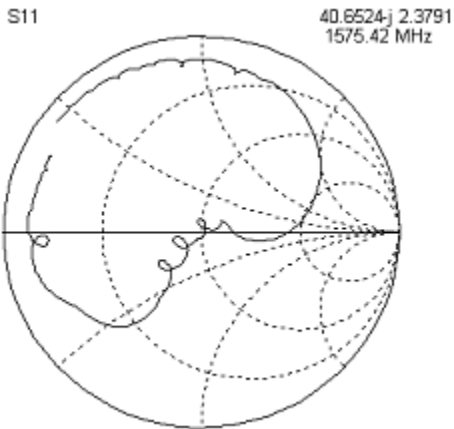

Oscilent Corporation - CALL **949.252.0522**
 17962 Sky Park Circle . Building D . Irvine . CA 92614 . USA
 Fax: 949.252.0599 . E-Mail: Sales@Oscilent.com

Part No.: **802-RF1575.42M-A**