

Description

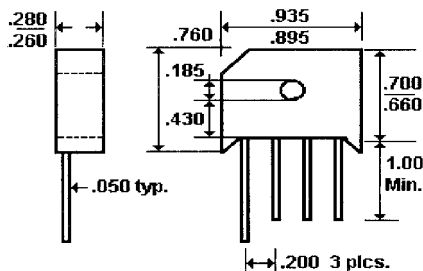

Mechanical Dimensions



Mechanical Data: Weight - 0.3 Ounces. Mounting Torque - 5.1 lbs. Mounting Position - Any.

Features

- **COMPACT SIZE**
- **250 AMP SURGE OVERLOAD RATING**
- **LOW LEAKAGE CURRENT**
- **MEETS UL SPECIFICATION 94V-0**

Electrical Characteristics @ 25°C.	KBU600 . . . 610 Series							Units
Maximum Ratings	KBU600	KBU601	KBU602	KBU604	KBU606	KBU608	KBU610	
Peak Repetitive Reverse Voltage... V_{RRM}	50	100	200	400	600	800	1000	Volts
RMS Reverse Voltage... $V_{R(rms)}$	35	70	140	280	420	560	700	Volts
DC Blocking Voltage... V_{DC}	50	100	200	400	600	800	1000	Volts
Average Forward Rectified Current... $I_{F(av)}$ $T_A = 25^\circ C$				6.0				Amps
Non-Repetitive Peak Forward Surge Current... I_{FSM} 8.3 mS Single ½ Sine Wave Imposed on Rated Load				250				Amps
Forward Voltage... V_F Bridge Element @ 6.0 Amps				1.0				Volts
DC Reverse Current... I_R @ Rated DC Blocking Voltage				10				μ Amps
				1.0				mAmps
Typical Thermal Resistance... $R_{\theta JC}$				10				°C/W
Operating Temperature Range... T_J				-55 to 125				°C
Storage Temperature Range... T_{STRG}				-55 to 150				°C

6.0 Amp SINGLE PHASE SILICON BRIDGE

KBU600 . . . 610 Series

Forward Current Derating Curve

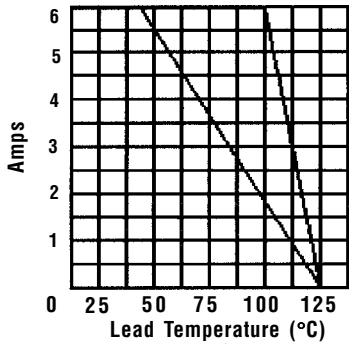

Non-Repetitive Peak Forward Surge Current

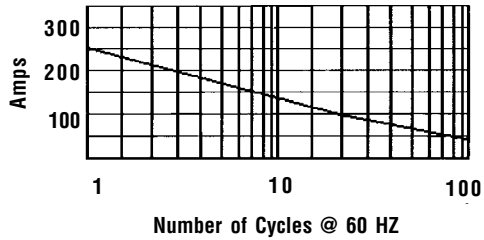

Typical Instantaneous Forward Characteristics

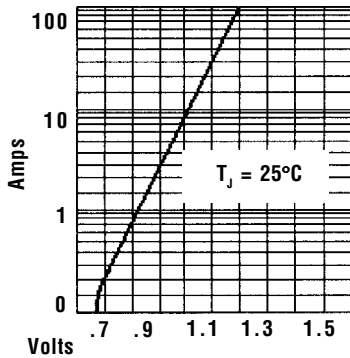

Typical Reverse Characteristics

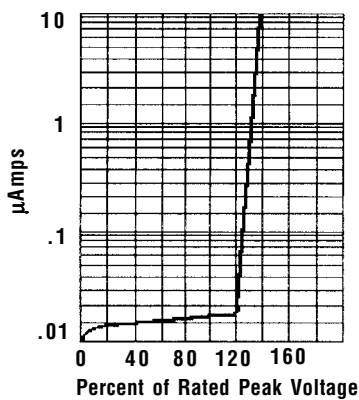

Typical Junction Capacitance

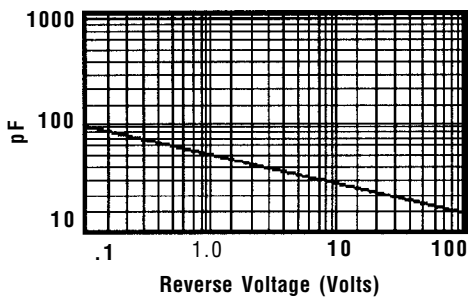

Electrical Description

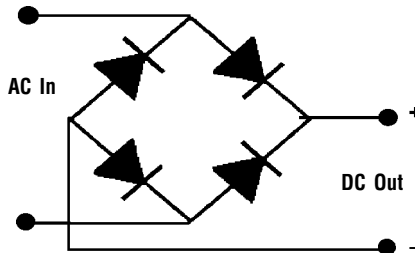

Ratings at 25 Deg. C ambient temperature unless otherwise specified.

Single Phase Half Wave, 60 HZ Resistive or Inductive Load.

For Capacitive Load, Derate Current by 20%.