

Electrical / Environmental

HM67

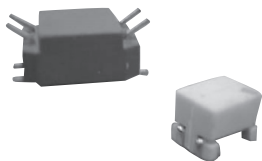

Surface Mount Common Mode Chokes

- Operating Temperature Range -40°C to +125°C
- Ambient Temperature, Maximum 85°C
- Temperature Rise, Maximum 40°C
- Dielectric Withstanding Voltage 300Vdc

Schematic

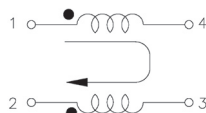

Specifications

Part Number	Terminals	Common Mode Inductance	Inductance Leakage	Rated Current mA	DCR (2)	Marking Code	Figure
		@ 100 kHz - 0.1 V (1-4 or 2-3) μ H	@ 100 kHz - 0.1 Vrms (1-4) ⁽¹⁾ Typ. μ H		Max. Ω		
HM67-B5R0LF	1-4, 2-3	5.0 \pm 30%	0.08	1000	0.12	A	1
HM67-B110LF	1-4, 2-3	11.0 \pm 30%	0.10	500	0.15	B	1
HM67-S250LF	1-4, 2-3	25.0 \pm 30%	1.60	500	0.18	C	1
HM67-B510LF	1-4, 2-3	51.0 \pm 30%	1.90	500	0.10	D	1
HM67-S510LF	1-4, 2-3	51.0 \pm 30%	2.80	500	0.25	E	1
HM67-B471LF	1-4, 2-3	470.0 \pm 30%	0.80	500	0.28	F	1
HM67-B102 ⁽³⁾ LF	1-4, 2-3	1000.0 +50%, -30%	0.16	500	0.30	G	1
HM67-B222 ⁽³⁾ LF	1-4, 2-3	2200.0 +50%, -30%	0.16	400	0.42	H	1
HM67-B472 ⁽³⁾ LF	1-4, 2-3	4700.0 +50%, -30%	0.24	200	0.67	I	1
HM67-10510LF	1-4, 2-3	51.0 \pm 30% ⁽⁴⁾	2.40 ⁽⁴⁾	200	0.403	0510	2

- Notes:
- (1) Leakage inductance is measured with pin 2 & 3 shorted.
 - (2) DC resistance is measured at 25°C.
 - (3) Maximum operating temperature is +85°C.
 - (4) Common mode inductance & leakage inductance of HM67-10510LF are measured at 100 kHz, 0.05V

Packaging

Standard: Embossed Tape & Reel

Reel:	Diameter:	Figure 1 & 2	=	13" (330.2mm)
	Capacity:	Figure 1	=	400 Units
		Figure 2	=	2000 Units

Ordering Information

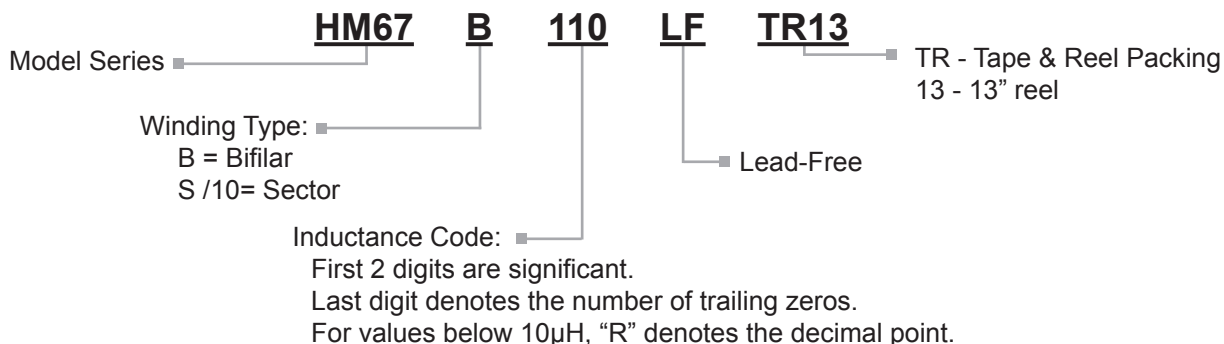

Outline Dimensions (Inch/mm)

Figure 1

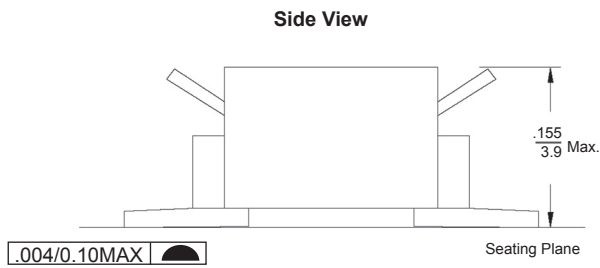
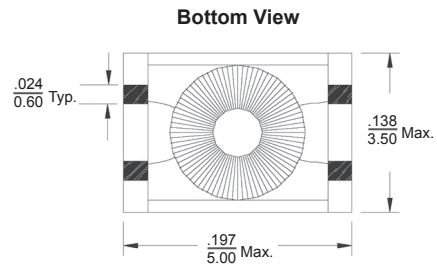
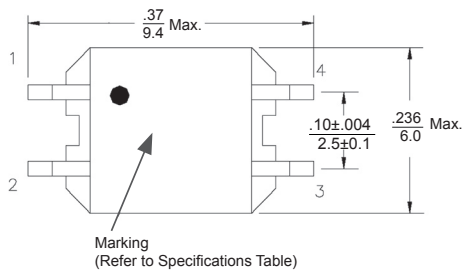

Figure 2



Top View



Top View

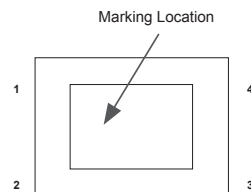

Side View

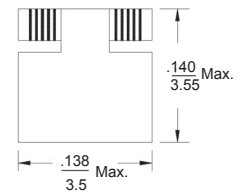

Recommended Solder Pad Layout

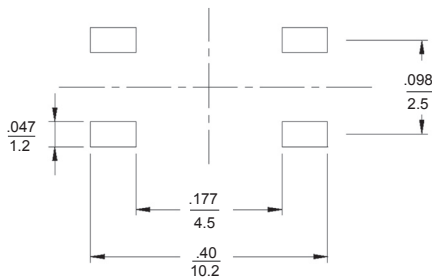

Recommended Solder Pad Layout

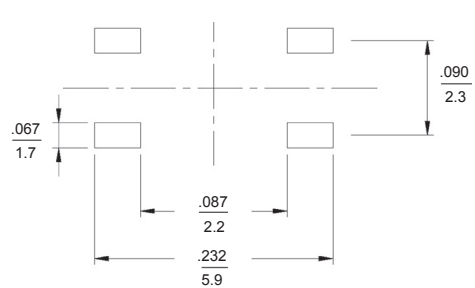

Electrical Characteristics @ 25 °C

(A) Attenuation vs. Frequency Graphs

HM67-B5R0LF

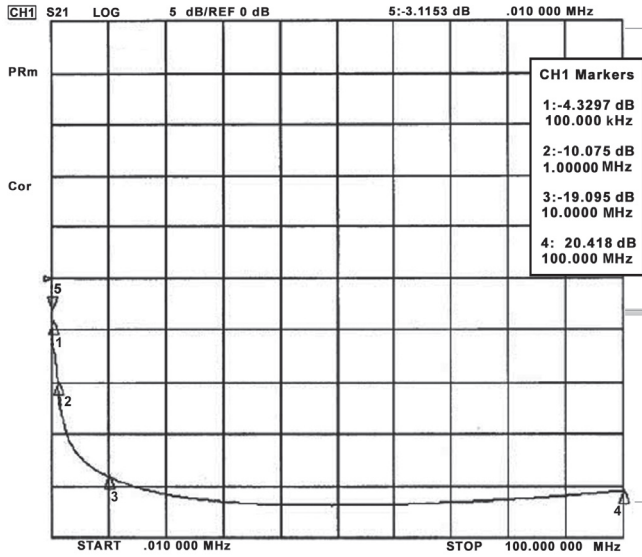

HM67-S250LF

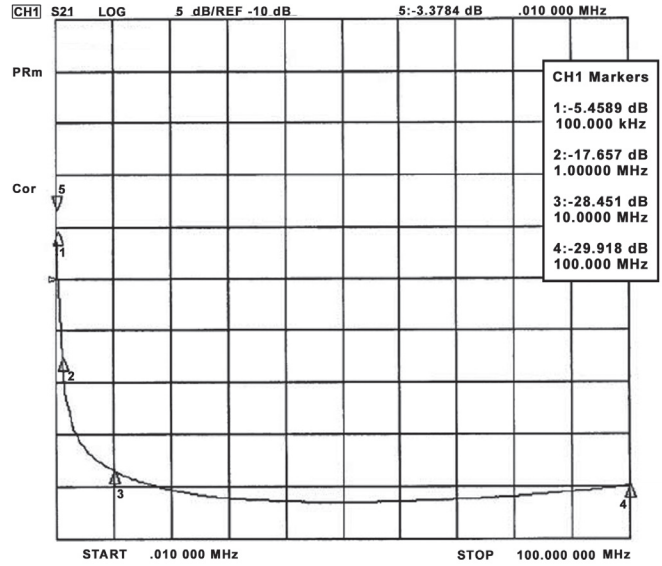

HM67-B110LF

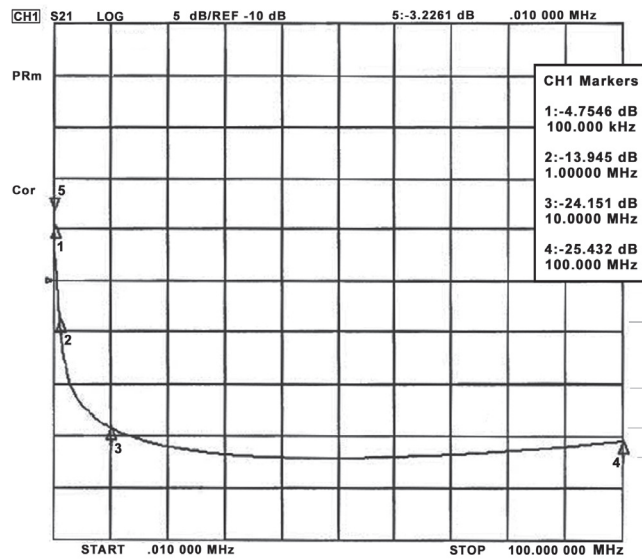

HM67-B510LF

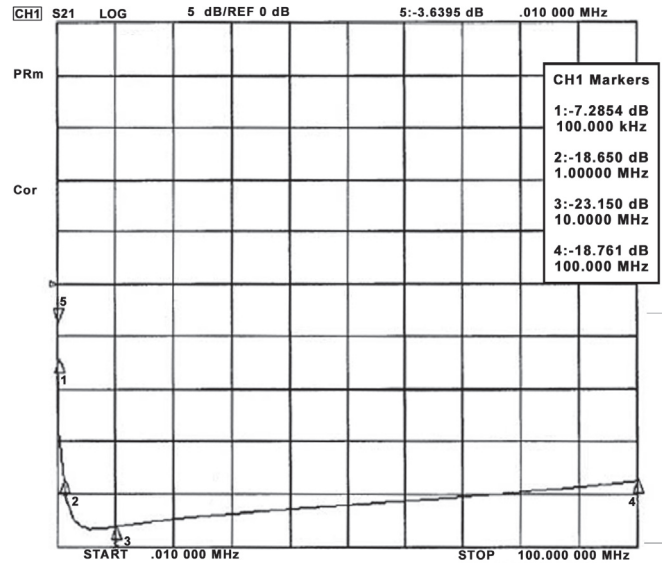

Electrical Characteristics @ 25 °C (Cont'd)

HM67-S510LF

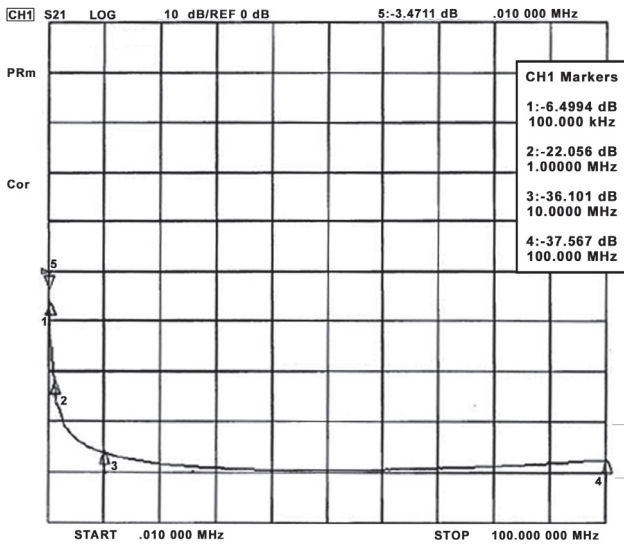

HM67-B102LF

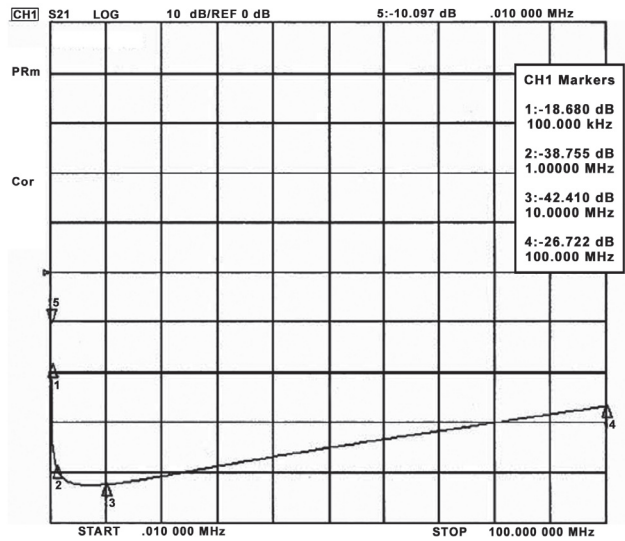

HM67-B471LF

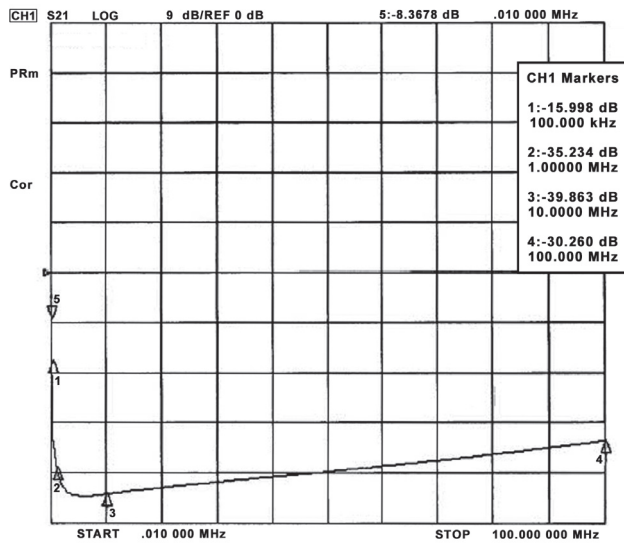

HM67-B222LF

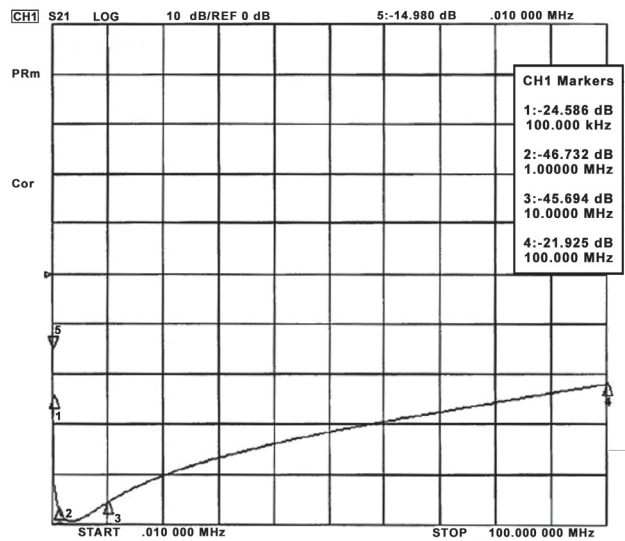

HM67-B472LF

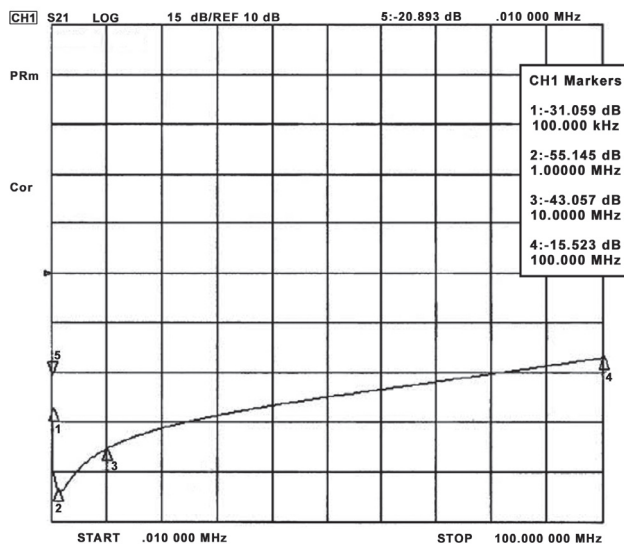

Electrical Characteristics @ 25 °C (Cont'd)

(B) Insertion Loss vs. Frequency Graph

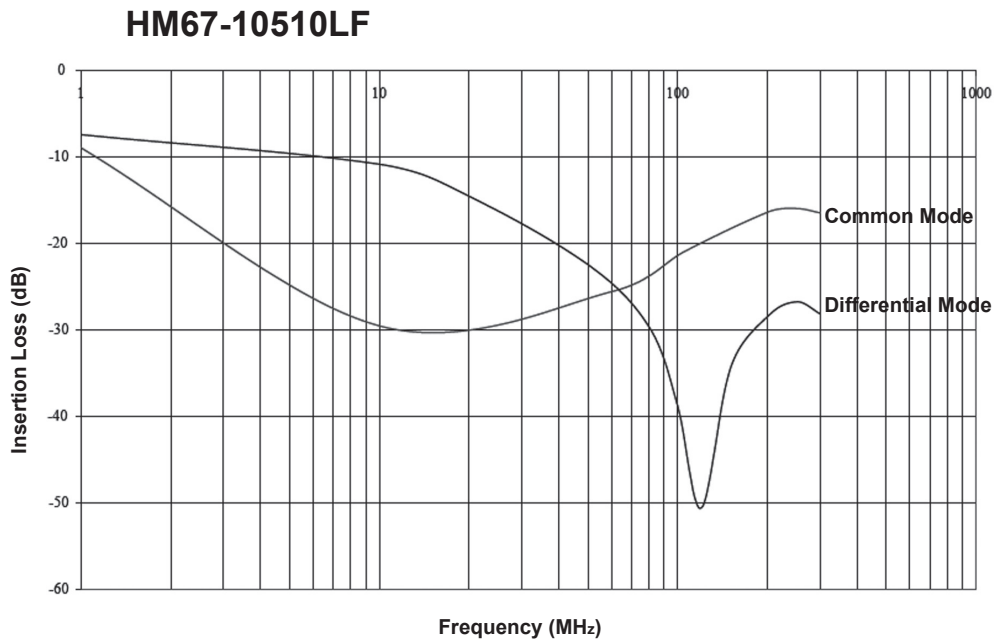

(C) Current Derating Curve

